



HEARTLAND 2050 REGIONAL PLANNING ADVISORY COMMITTEE (H2050 RPAC)

Heartland 2050 is a community driven initiative pulling in stakeholders from across the region to think big and work towards a common vision for our six county region anchored by the Omaha-Council Bluffs metro area.

MEETING MINUTES

Friday, October 4, 2024 | 10:00 a.m. – 12:00 p.m.

Meeting held at La Vista City Hall Annex Building, 8116 Park View Boulevard, La Vista

MEMBERS:

In-Person: Keith Station, Chris Gibbons, Ashley Rae Turner, Brian Lodes, Bruce Fountain, Chris Shewchuk, Dr. Terry Haack, Kelly Jeck, Jody Holston, Kent Holm, Kristine Stokes, Laura Dietrich, Mark Norman, Meghan Engberg, Mike McIntosh, Travis Gibbons, Vicki Quaites-Ferris

Virtual: Jeff Spiehs, Stephanie Mueller

GUESTS: Cole Broderson (City of La Vista), Marcus Chaffee (Omaha Documenters), Tammi Palm (City of Bellevue)

MAPA STAFF: Mike Helgerson, Laura Heilman, Sue Cutsforth, Saul Lopez, Carlos Morales, Lindsey Button, Grant Anderson

A. Welcome and Introductions – Keith Station, Committee Chair

B. Approval of Past Meeting Minutes - Keith Station, Committee Chair - **ACTION**

- a. Members voted unanimously to approve meeting minutes for the April 5 2024, June 7 2024, and August 2 2024 committee meetings.

C. La Vista City Centre District: Bruce Fountain, City of La Vista

- a. Bruce Fountain shared the development of the La Vista City Centre development from the original Vision 84 Plan from 2010 to current development as well as future plans.
 - i. Vision 84 Plan: <https://cityoflavista.org/704/Vision-84>
 - ii. La Vista City Centre: <https://lavistacitycentre.com/>

D. La Vista Active Mobility Plan: Bruce Fountain, City of La Vista

- a. Bruce Fountain and Cale Broderson shared information about the La Vista Active Mobility Plan currently in development
 - i. Plan is intended to strengthen active mobility options in the City, including walking and biking opportunities
 - ii. Final plan is expected to be adopted in January 2025
 - iii. <https://www.cityoflavista.org/2311/Active-Mobility-Plan>

E. Additional Business

1. Heartland 2050 Committee Updates

- a. **Equity & Engagement and Housing & Development:** Ashley Rae Turner, Omaha Municipal Land Bank and Jeff Spiehs, Lamp Rynearson
 - i. The Equity & Engagement and the Housing & Development Committees have been holding joint meetings to coordinate their work

HEARTLAND 2050 GUIDING PRINCIPLES

EQUITY | INCLUSIVITY | EFFICIENCY | LOCAL CONTROL/REGIONAL BENEFIT



- ii. There is a Heartland 2050 Committee December Social event being planned for Tuesday, December 10th from 3-4:30 pm
 - 1. All Heartland 2050 committee members and the public are invited to this fun event to celebrate the work of the committees during the past year - more information coming soon!
- iii. At the last meeting, the group heard from Restoring Dignity about their work to support Omaha's refugee communities
 - 1. <https://rdomaha.org/>
- iv. At the upcoming meeting, the group will hear from:
 - 1. Clarice Dombeck with the National Redress Movement
 - a. The Redress Movement is a newly formed nonprofit organization that empowers communities across the U.S. to take direct action to redress racial segregation.
 - b. <https://redressmovement.org/omaha/>
 - 2. Marcus Chaffee, about his work on the Omaha LGBTQIA+ History Mapping Project
 - a. This project will result in a publicly available digital map highlighting significant places for Omaha's LGBTQIA2S+ history
 - b. <https://www.preserveomaha.org/ourmap>
- b. **Infrastructure:** Mike McIntosh, Lamp Rynearson
 - i. At their last meetings, the group has heard from:
 - 1. Steven Jensen about the Omaha Streetcar Project
 - 2. Nancy Pridal with Lamp Rynearson about the bond issues on the ballot for the City of Omaha in the upcoming election
 - 3. Robert Larocco about the City of Omaha's Climate Action and Resilience Plan
 - ii. Working groups continue to work on their topics of interest
- c. **Natural Resources:** Kent Holm, Douglas County
 - i. The committee is reviewing their working groups in order to support implementation of the City of Omaha's Climate Action and Resilience Plan
 - ii. Solid Waste working group continues to work on issues around lithium battery disposal and potential Nebraska legislation about extended producer responsibility for the lifecycles of their products and packaging, as well as solutions for organic waste

2. MAPA Updates

- a. Register now for MAPA's Annual Meeting
 - i. tinyurl.com/COOAnnualMtg24
 - ii. Wednesday, October 9th
 - iii. Featuring keynote presentation by Kevin Belle, Project Manager for the Great American Rail-Trail project
 - 1. <https://www.railstotrails.org/site/greatamericanrailtrail/>
 - iv. MAPA is also hosting a Trails Workshop with Kevin Belle to discuss trail connections around the Great American Rail-Trail through Iowa
 - 1. Will be held in Neola, Iowa on October 9th
- b. The Nebraska Department of Economic Development is hosting Housing Listening Sessions to capture feedback about the agency's housing programs

HEARTLAND 2050 GUIDING PRINCIPLES

EQUITY | INCLUSIVITY | EFFICIENCY | LOCAL CONTROL/REGIONAL BENEFIT



- i. Meeting in Omaha is on 10/23 at 1:30 pm at the Benson Branch Library
 - ii. Registration is required
- c. MAPA is hosting a free training from FHWA on updates to the Manual on Uniform Traffic Control Devices; space is limited - contact MAPA transportation staff if you'd like to attend.
- d. Safe Streets for All (SS4A) Safety Survey Open Now
 - i. www.mapacog.org/projects/ss4a
 - ii. MAPA is leading the development of a regional Comprehensive Safety Action Plan; visit the link about to share your safety concerns with our team
- e. Two Long Range Transportation Surveys are also open now
 - i. The Transportation Management Area (TMA) covers Douglas, Sarpy and the urbanized portion of Pottawattamie County
 - 1. <https://lrtp-2050-update.mapacog.org/>
 - ii. Regional Planning Affiliation 18 (RPA-18) covers Harrison, Shelby, Mills and the non-urban portion of Pottawattamie County
 - 1. www.mapacog.org/projects/rpa18-lrtp/
- f. Regional Brownfields Coalition Grant
 - i. EPA is opening a grant for Brownfield Revolving Load Fund
 - 1. Applications due by November 14
 - 2. MAPA is working with partners to discuss potential applications; contact us if you'd like to be included
- g. Civil Rights Policy Update
 - i. Outlines how laws and federal regulations, specifically those prohibiting discrimination, are implemented in MAPA's processes
 - 1. Includes MAPA's Title VI Policy as well as the complaint process for both Title VI and ADA
 - ii. Updated every three years
 - iii. Planning to open a comment period on the draft updated policy in November 2024 with the plan approved in January 2025
 - 1. www.mapacog.org/about/what-is-map/civil-rights/
- h. Upcoming Call for Projects
 - i. Two calls for projects will open in October
 - ii. Local units of government including cities, counties and public transit agencies can apply for federal transportation funding
 - iii. The Transportation Management Area (TMA) covers Douglas, Sarpy and the urbanized portion of Pottawattamie County
 - 1. www.mapacog.org/projects/tip/
 - iv. Regional Planning Affiliation 18 (RPA-18) covers Harrison, Shelby, Mills and the non-urban portion of Pottawattamie County
 - 1. www.mapacog.org/projects/rpa-18/
- i. Open RFP's/RFQs
 - i. Housing Market Value Analysis RFP
 - 1. Analysis will help establish a baseline of market conditions, benchmark progress and serve as a policy framework
 - 2. Funded through a grant from the Development and Preservation Fund of Front Porch Investments

HEARTLAND 2050 GUIDING PRINCIPLES

EQUITY | INCLUSIVITY | EFFICIENCY | LOCAL CONTROL/REGIONAL BENEFIT



- ii. On-Call Travel Demand Model RFQ
 - 1. To assist with MAPA's traffic modeling and traffic forecasting activities
- iii. City of Minden, Iowa Housing Developer RFP
 - 1. To submit an application for the 2019 Community Development Block Grant Disaster Recovery – Housing (CDBG-DR) program through the Iowa Economic Development Authority (IEDA)
- iv. View open RFPs/RFQs or join the mailing list at www.mapacog.org/about/rfp-rfq/

3. Community Updates

- a. Council Bluffs
 - i. Council Bluffs and Mills County have finalized an agreement to annex property for a large new subdivision
 - ii. Iowa Economic Development Authority has named Council Bluffs a Thriving Community for its commitment to creating affordable housing opportunities for residents at all income levels
 - 1. <https://www.councilbluffs-ia.gov/CivicAlerts.aspx?AID=430>
 - iii. Another large subdivision with approximately 1000 units on 94 acres is being planned
 - iv. The Council Bluffs Planning and Environmental Linkages study is looking at options for multimodal transportation along the West Broadway / First Avenue corridor
 - 1. <https://www.councilbluffs-ia.gov/2571/Linkages-Study>
- b. Nebraska Planning & Zoning Association (NPZA) is hosting an online workshop next Friday
- c. La Vista will be hosting a Nebraska Economic Development Association event with Grow Sarpy on May 28-30 2025
- d. The International Association of Public Participation (IAP2) is planning a Midwest Conference in April 2025 and will be looking for presenters

G. Public Comment - There was no request for public comment

H. Adjourn

Future Meetings & Events:

MAPA Council of Officials Annual Meeting - October 9, 2024
H2050 Regional Planning Advisory Committee – December 6, 2024



Heartland 2050 Regional Planning Advisory Committee (RPAC)

October 4, 2024

NEBRASKA OPEN MEETINGS ACT

This meeting of the Metropolitan Area Planning Agency Heartland 2050 Regional Planning Committee will be conducted in compliance with the Nebraska Statutes of the Open Meetings Act.

MAPA staff have a copy of the Open Meetings Act available for your reference.



MEETING LIVESTREAM

- MAPA is livestreaming public meetings, including RPAC, to YouTube
 - www.youtube.com/@MAPA2222
 - Meetings can be watched live online
 - Find recordings under the 'Live' category or in a specific playlist

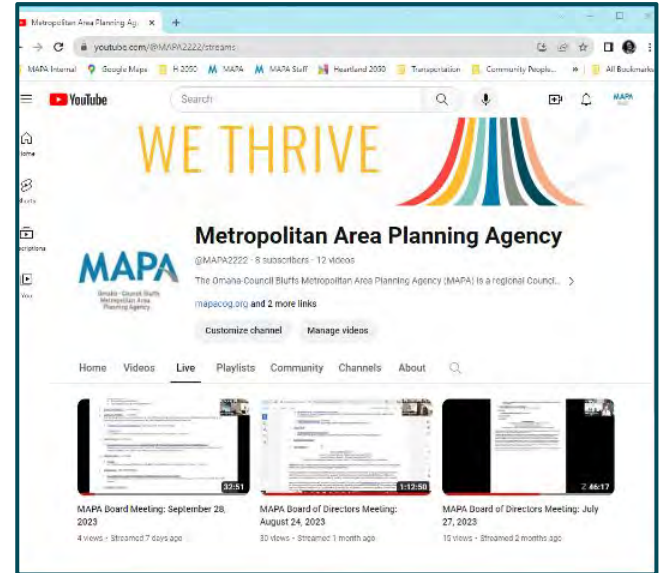

AGENDA

1. Welcome & Introductions
2. Approval of Past Meeting Minutes
3. La Vista City Centre
4. La Vista Active Mobility Plan
5. Additional Business
 - a. Committee Updates
 - b. MAPA Updates
 - c. Community Updates
6. Public Comment
7. Adjourn



WELCOME & INTRODUCTIONS

Keith Station, Committee Chair

Please add your name and organization to the chat if you are joining virtually



APPROVAL OF MINUTES

April 5 2024

June 7 2024

August 2 2024



LA VISTA CITY CENTRE

Bruce Fountain, City of La Vista



La Vista's 84th Street Redevelopment MAPA RPAC Meeting- 10/4/24

Agenda

- The Golden Mile
- Vision 84
- City Centre – Public/Private Partnerships
to Create Event + Entertainment Focus
- Next Steps and Projects

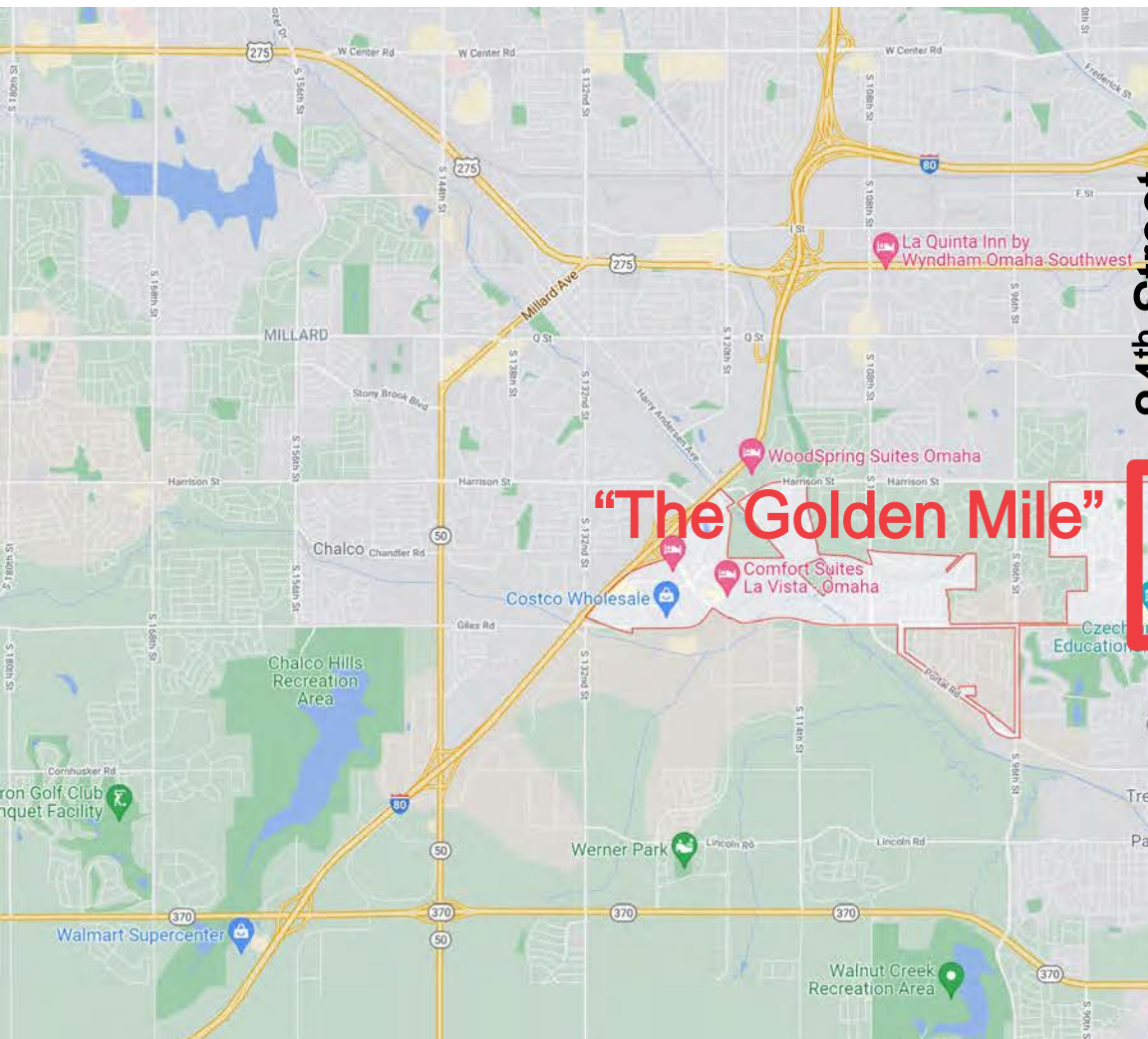

Omaha

84th Street

Ralston

La Vista

Papillion

"The Golden Mile"

The Golden Mile



The Golden Mile

- La Vista's stretch of 84th Street from Giles Road to Harrison Street has been the **City's main economic center** since La Vista was established in 1960. It came to be known as The Golden Mile with businesses such as **Wal-Mart, Baker's Supermarket, Gordman's, Hobby Lobby** and **Summer Kitchen** as main draws along the corridor.
- The decline of 84th Street began when Wal-Mart **closed in 2006** followed by the closing of Baker's in 2008.
- The City has led significant public planning efforts over several years to **chart a new course for the future**.

Previous Conditions



Summer Kitchen

Hobby Lobby

Walmart

FNB

Chilis

FedEx Kinkos

Previous Conditions



Vision 84



City of La Vista

A Vision Plan for 84th Street



Vision 84

Vision Statement:

“The Corridor will be the central city core, with a memorable and distinct identity, a vibrant mix of land uses, a sense of community and a high quality of life for residents.”

Principles:

1. Make 84th Street economically attractive & sustainable
2. Create a distinct, enduring, appropriate built environment
3. Attract people to the 84th Street Corridor.
4. Create a place to live, work, and play.
5. Provide human-scaled quality environments.
6. Encourage social interaction and community events.
7. Connect to existing neighborhoods.
8. Restore and enhance the natural environment.
9. Respect and enhance adjacent neighborhoods.

Vision 84



Vision 84 Follow Up Plans

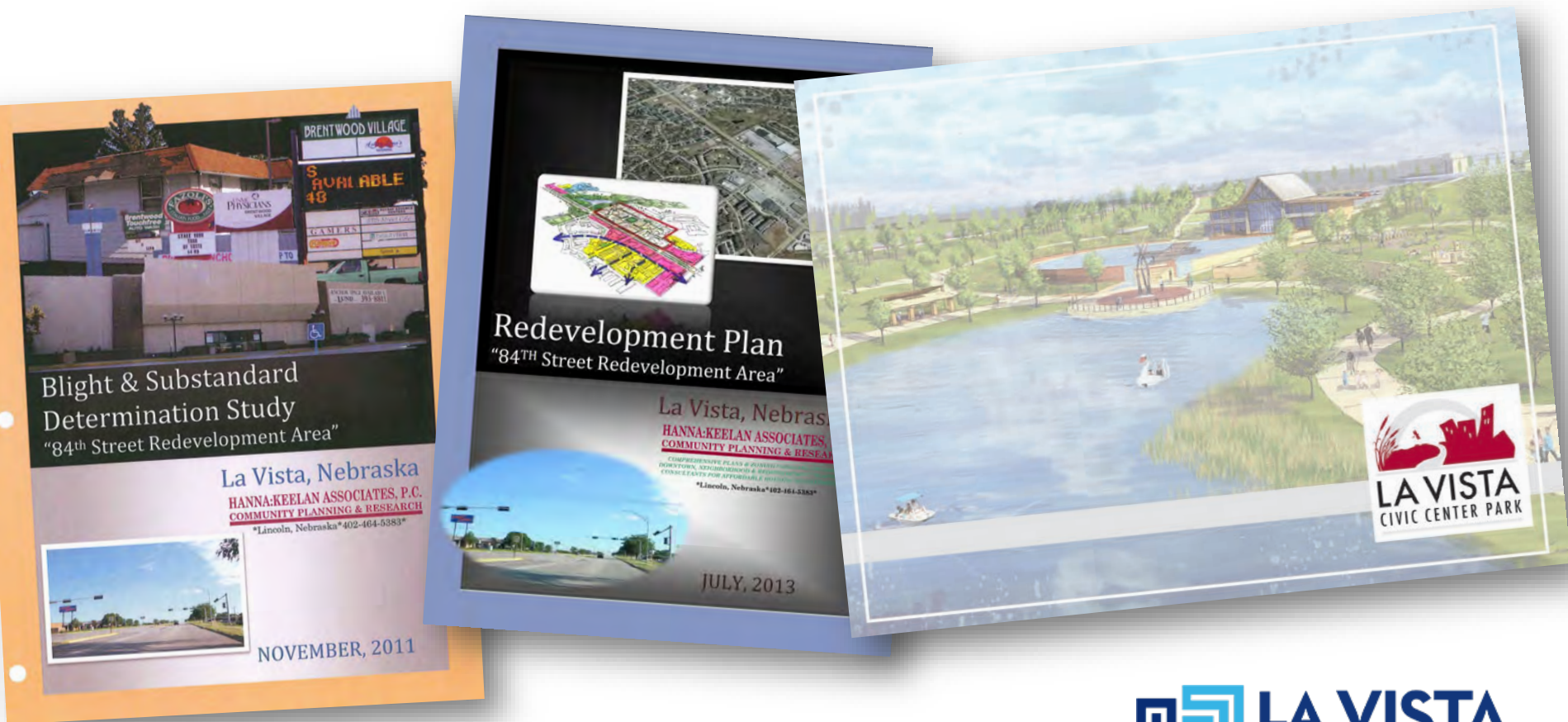

City Centre – Public/Private Partnership w/ City Ventures

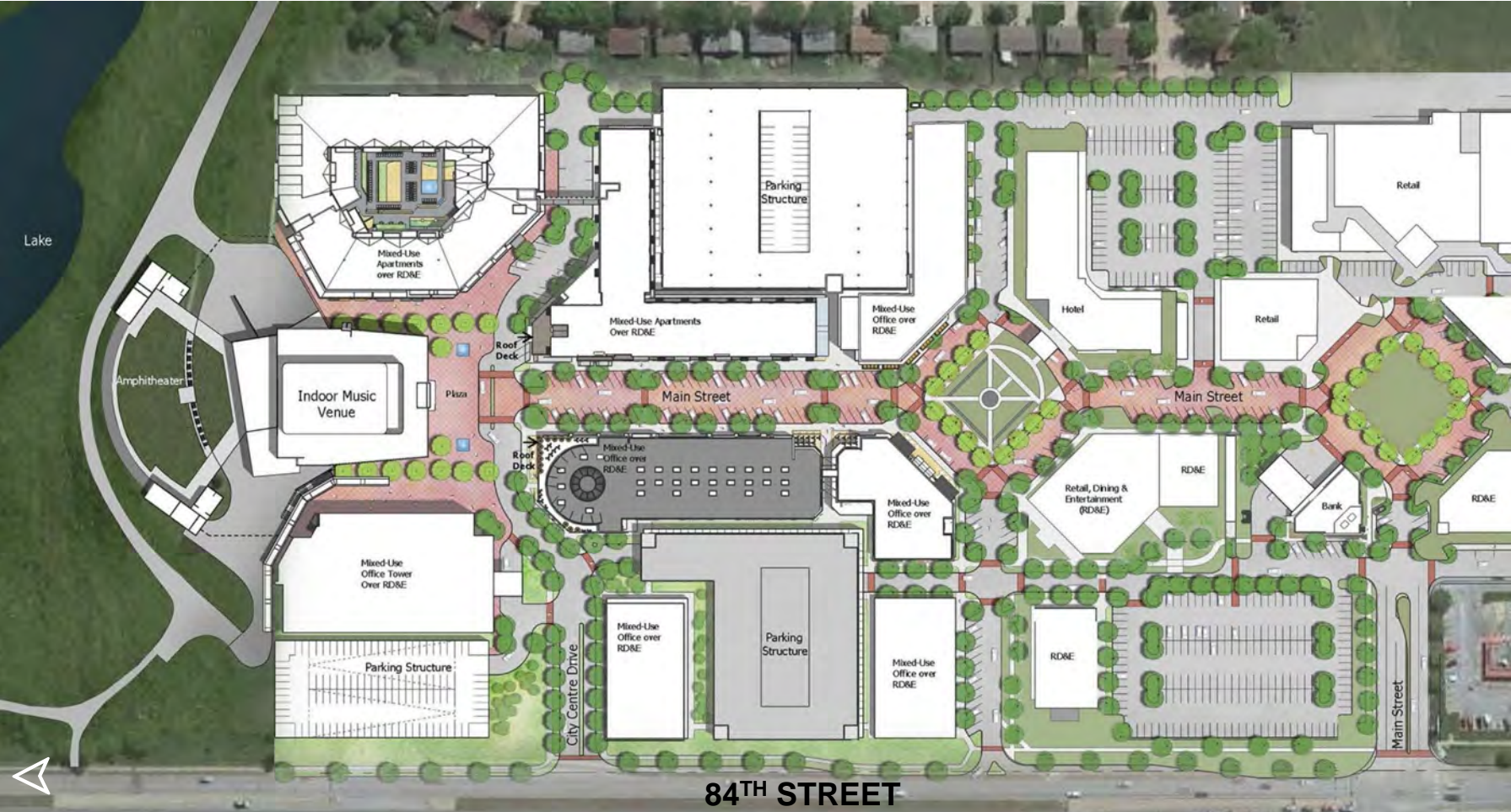

City Centre – Public/Private Partnership



City Centre – Public/Private Partnership



City Centre – Public/Private Partnership



City Centre – Public/Private Partnership





La Vista's first builders designed simple, affordable homes giving the average, working family the opportunity to experience homeownership for the first time. Each home was sold for **\$9,999** with a \$200 down payment, and soon was referred to as a **"House of Nines."**

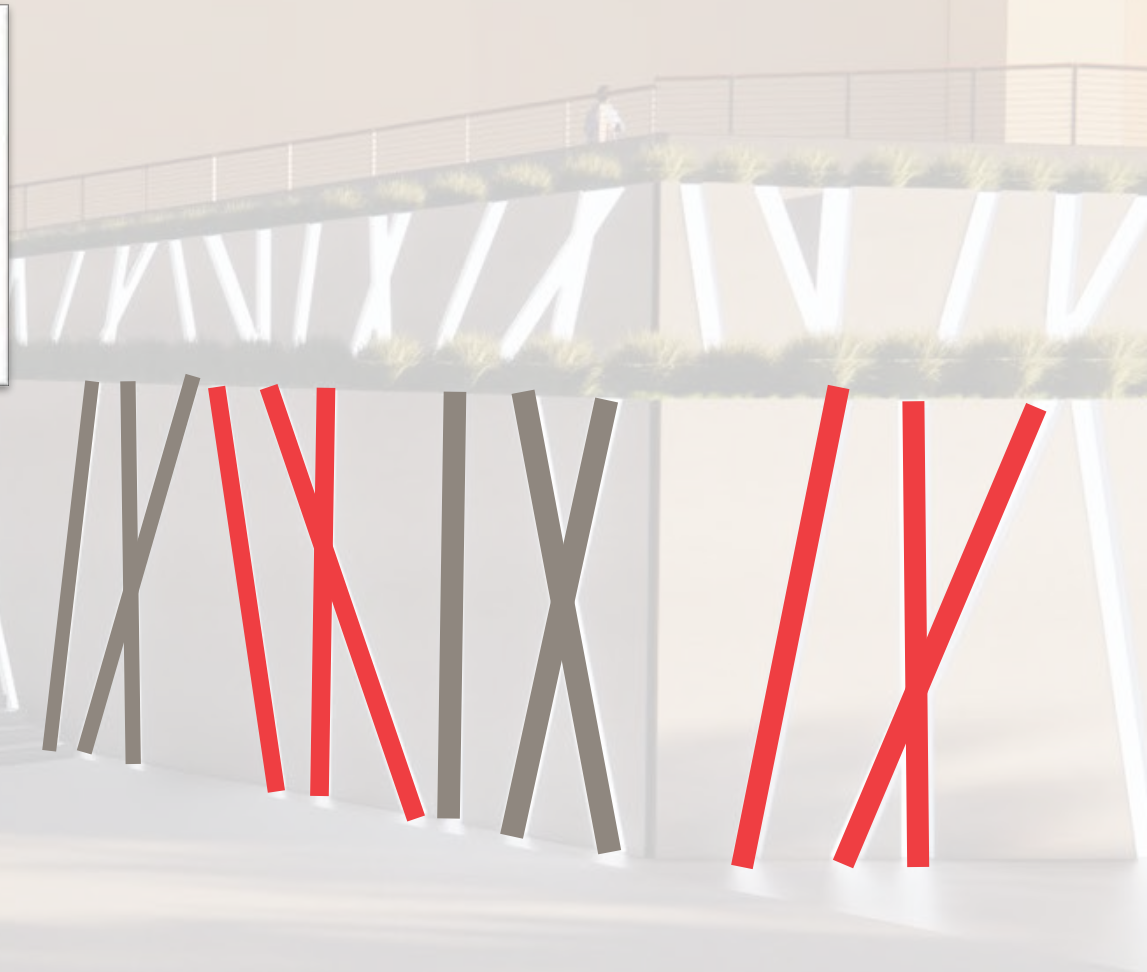

"Wall of Nines"

City Centre – Public/Private Partnership



City Centre – Public/Private Partnership



City Parking Garage 2

Next Steps and Projects

84th Street Streetscape

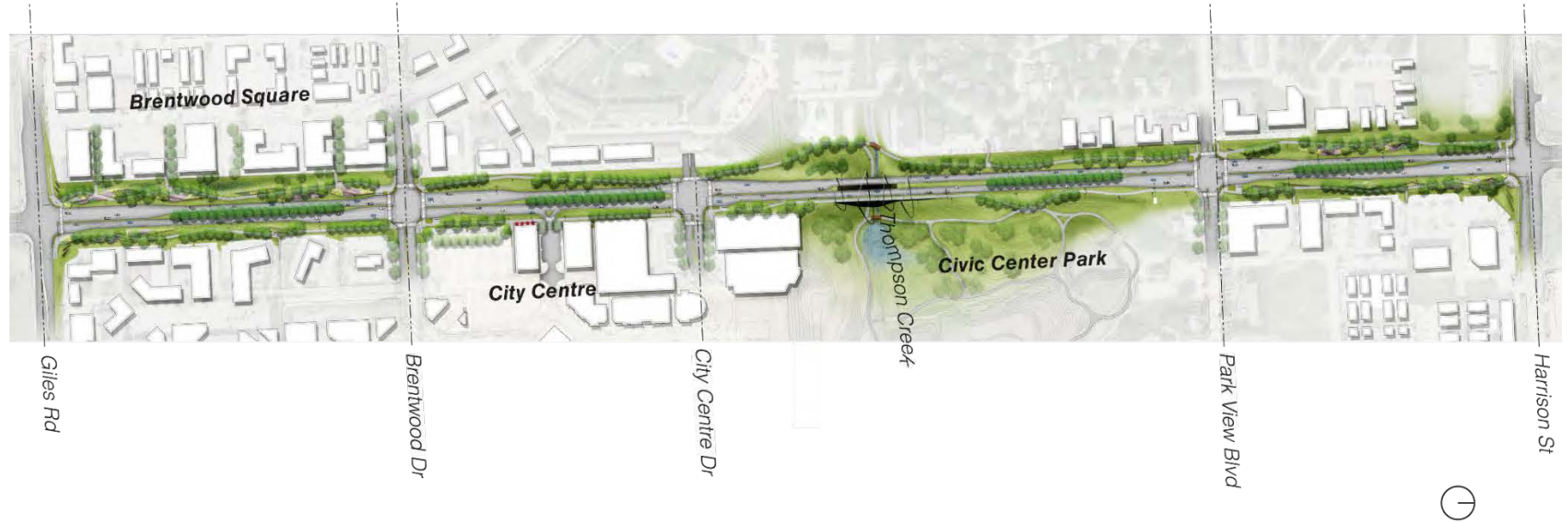

Future Streetscape



Giles Intersection

Streetscape—Site Furniture + Signage

Wayfinding + Signage

Comprehensive signage and wayfinding



Site Furniture

Modern, comfortable seating and site amenities

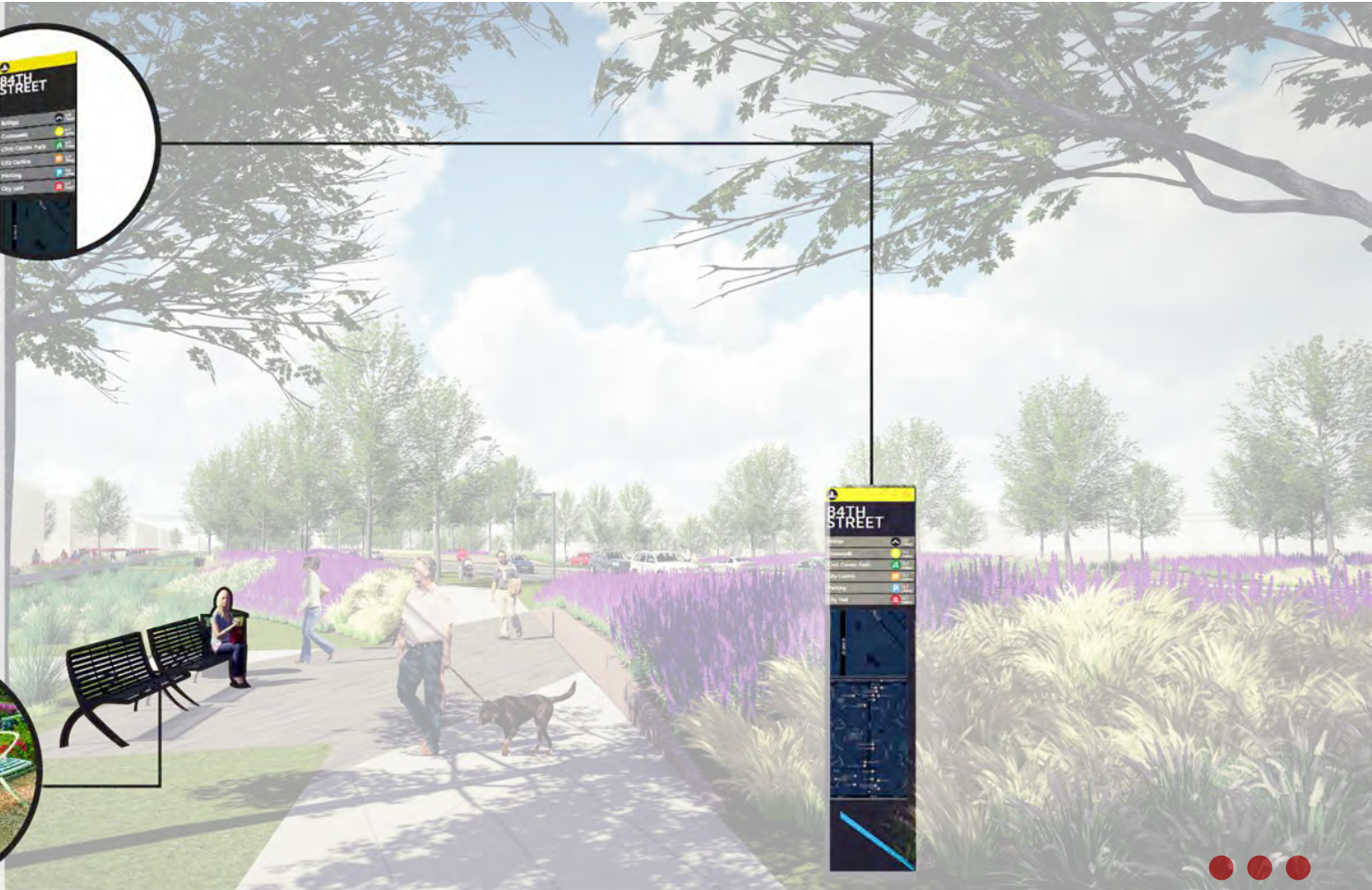

Next Steps and Projects

Town Square Programming

City Centre Commons

- Entry for events
- Gateway to the Park
- Integrated Wayfinding
- Protective Design
- Non-event interest – Water

Barmettler Square

- The Heart of City Centre
- Enclosure through Structure
- Mostly Hardscape
- Flexible Seating
- Temporary Uses: e.g., Bookmobile, Coffee Cart
- The Launchpad/Landmark

Main Street Square

- Green Backdrop
- Enclosure through Trees
- Front Lawn Feel
- Flexible / Sculptural Seating
- Potential for Public Art



Barmettler Square-Proposed

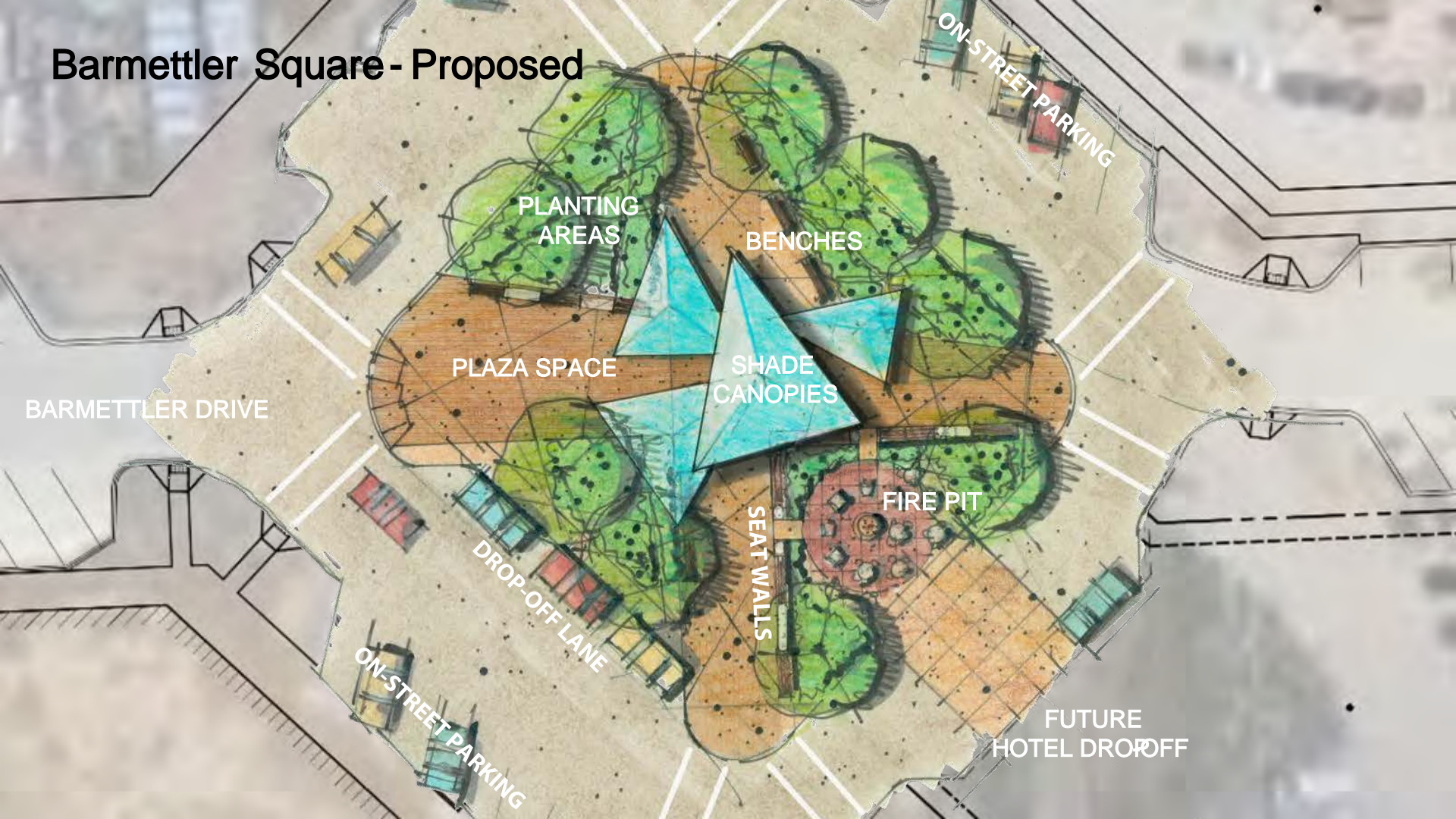

Main Street Square- Proposed

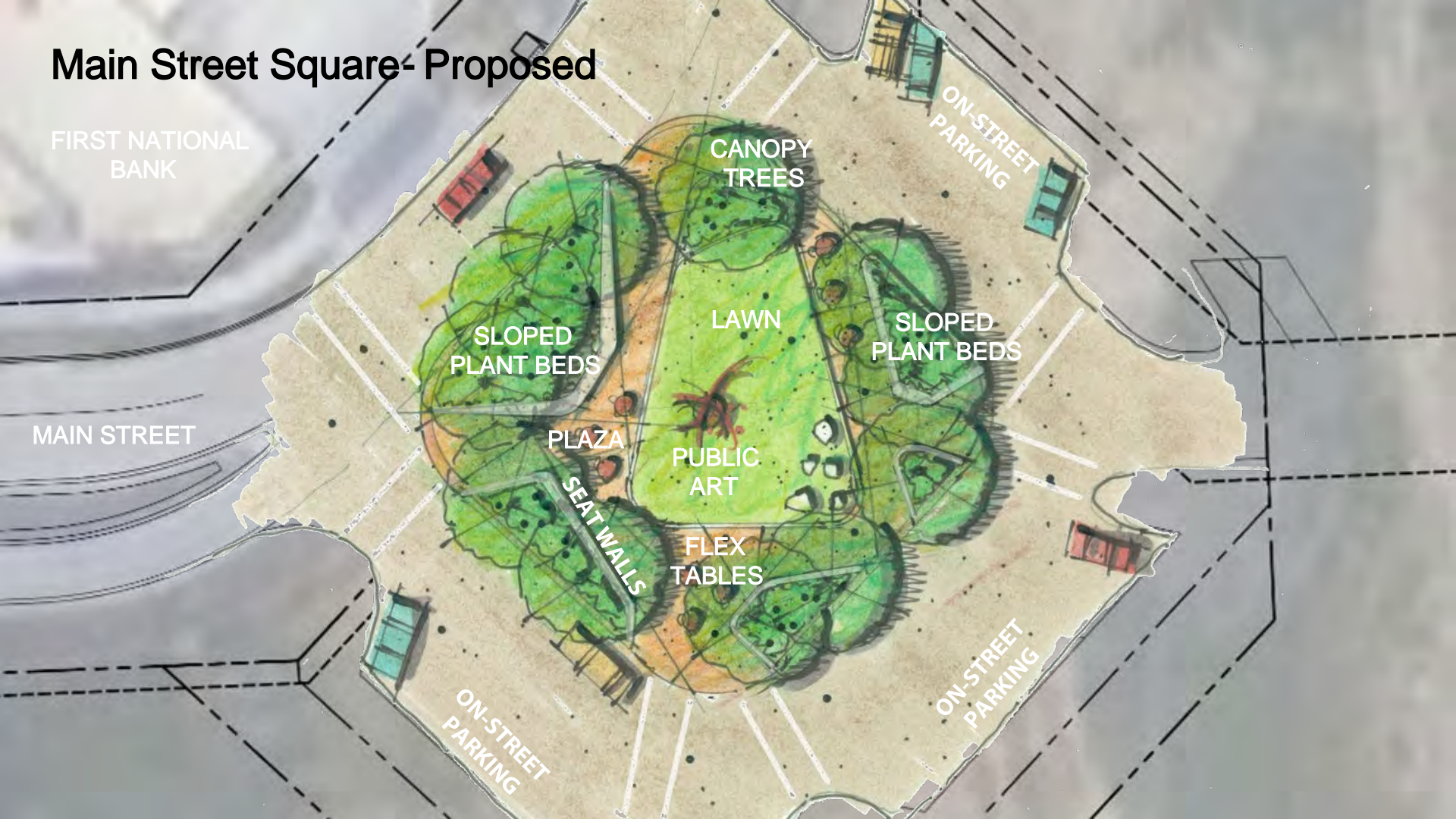

Next Steps and Projects – 84th Street Bridge/Underpass



Next Steps and Projects – Central Park West



BIRCH DR.

SMALL
PLAYGROUND

CHANNELIZED
THOMPSON CREEK

TWO BALL FIELDS

85TH

SAND
VOLLEYBALL

SWIMMING
POOL

87TH STREET

84TH STREET

Next Steps and Projects – Central Park West





Active Mobility Plan

Help us improve access to our sidewalks & trails!



We heard from nearly 200 respondents.

90% of respondents use active mobility for recreation, health, fitness, school, work, or errands.

What age are our active mobility users?

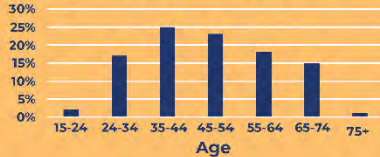

People from all age groups told us they use active mobility.

Do you have vehicle access?

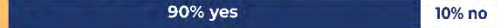

How often do you use human-powered active mobility?

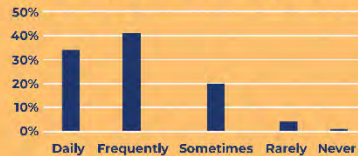

75% of respondents use active mobility frequently (3 days a week or more).

17% of respondents use electric-assist active mobility frequently (3 days a week or more).

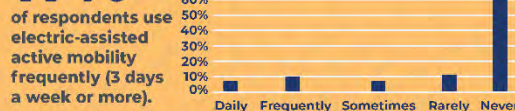

Where are people going?

Family Fare
84th St Corridor
Downtown Midland
CVS
Brentwood Square
Access Bank
Costco
Shopping / Retail
Walmart
Shadowlawn Town Center
Cabela's
66th & Giles Area
84th & Giles

Portal
Elementary School
Schools
La Vista Middle School
Papio La Vista High School
La Vista West Elementary

Tennis Courts
Cinnabar Park
Zorinsky Lake Trail
Appelwood Creek Trail
Keystone Trail
Central Park
Chalco Recreation Area
Soymour Smith Park
Chalco Park
Dog Park
La Vista Sports Complex
Chalco Hills
Chalco Park
Papillon Landing
Bellevue Berry Farm
Ardmore/Hunter's Creek
Echo Hills Park

Library
City Centre
Civic / Entertainment
Alamo Draft House
Liberty First Credit Union Arena
La Vista Community Center
St. Columbian Church
Aviture
Café Diem
Heights Tap Room
Coffee Society
Pint Nine
Eating / Dining
Kros Strain
Lucky Bucket Brewery
Dunkin' Donuts
Dairy Queen

What we heard

We asked,
"Have you encountered any limitations using active mobility?"



We asked,
"What is one priority within La Vista that could be improved to make active mobility easier or safer?"



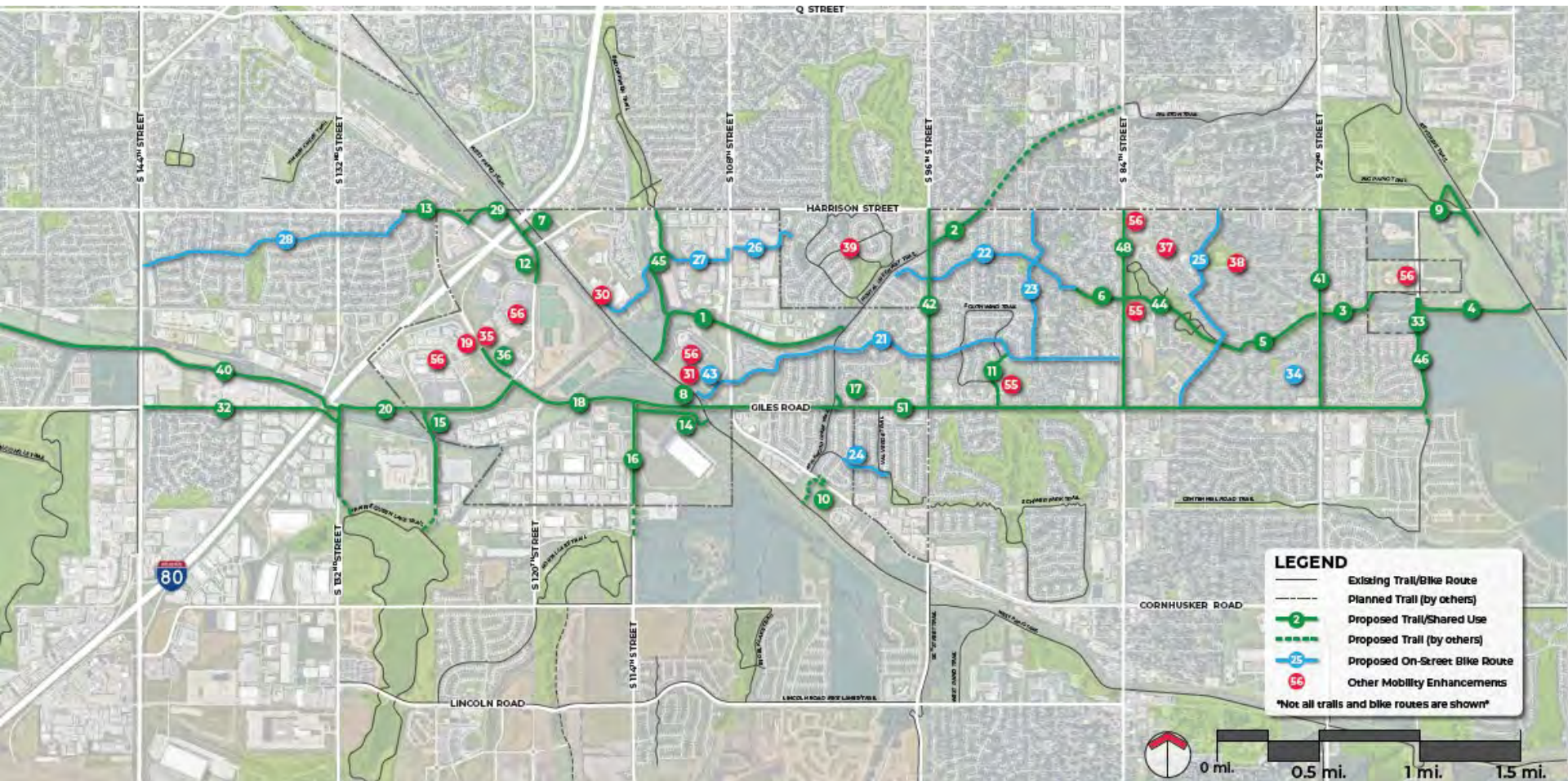

LA VISTA ACTIVE MOBILITY PLAN

Bruce Fountain, City of La Vista



**OVER 100 IDEAS
DISTILLED INTO 80 CONCEPTS...**

...TO IMPROVE ACTIVE MOBILITY!



La Vista Active Mobility Plan

Preliminary Project Proposals

PROPOSED SHORT-TERM PROJECTS

EASY WINS

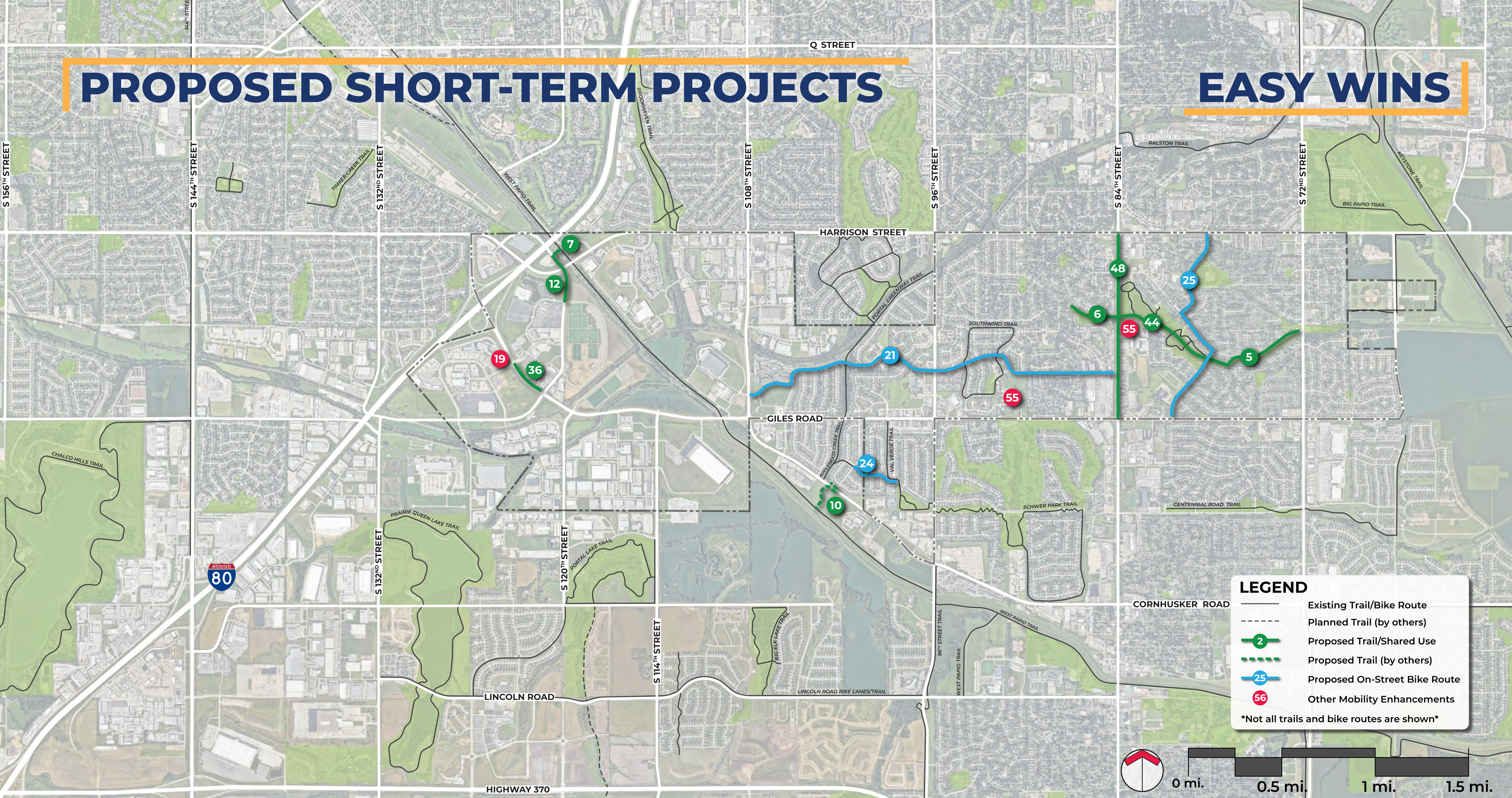

5 Thompson Creek Trail from Central Park to 72nd Street

6 Central Park to Central Park West Trail extension from City Centre to Valley View Drive

7 Bridge over West Papio Creek from trail to Southport

10 Portal Road crossing and West Papio Trail connection

12 Shared use path along Eastport Parkway from new West Papio Creek bridge

36 Giles Road Trail from Southport Parkway to Eastport Parkway

44 Central Park interior trail improvements

48 84th Street Trail (along both sides) from Giles to Harrison

21 Brentwood Drive bike route, 84th to 108th

24 On-street bike route on West Centennial Road, Applewood Creek Trail to Val Verde

25 Bike boulevard along Edgewood Boulevard, Parkview Boulevard, and 78th Street, Giles to Harrison

19 Giles Road / Southport Parkway at-grade crosswalk improvements

55 Heartland bike share stations near City Centre and at City Library/MCC

PROPOSED NEAR-TERM PROJECTS

DESIRED NETWORK

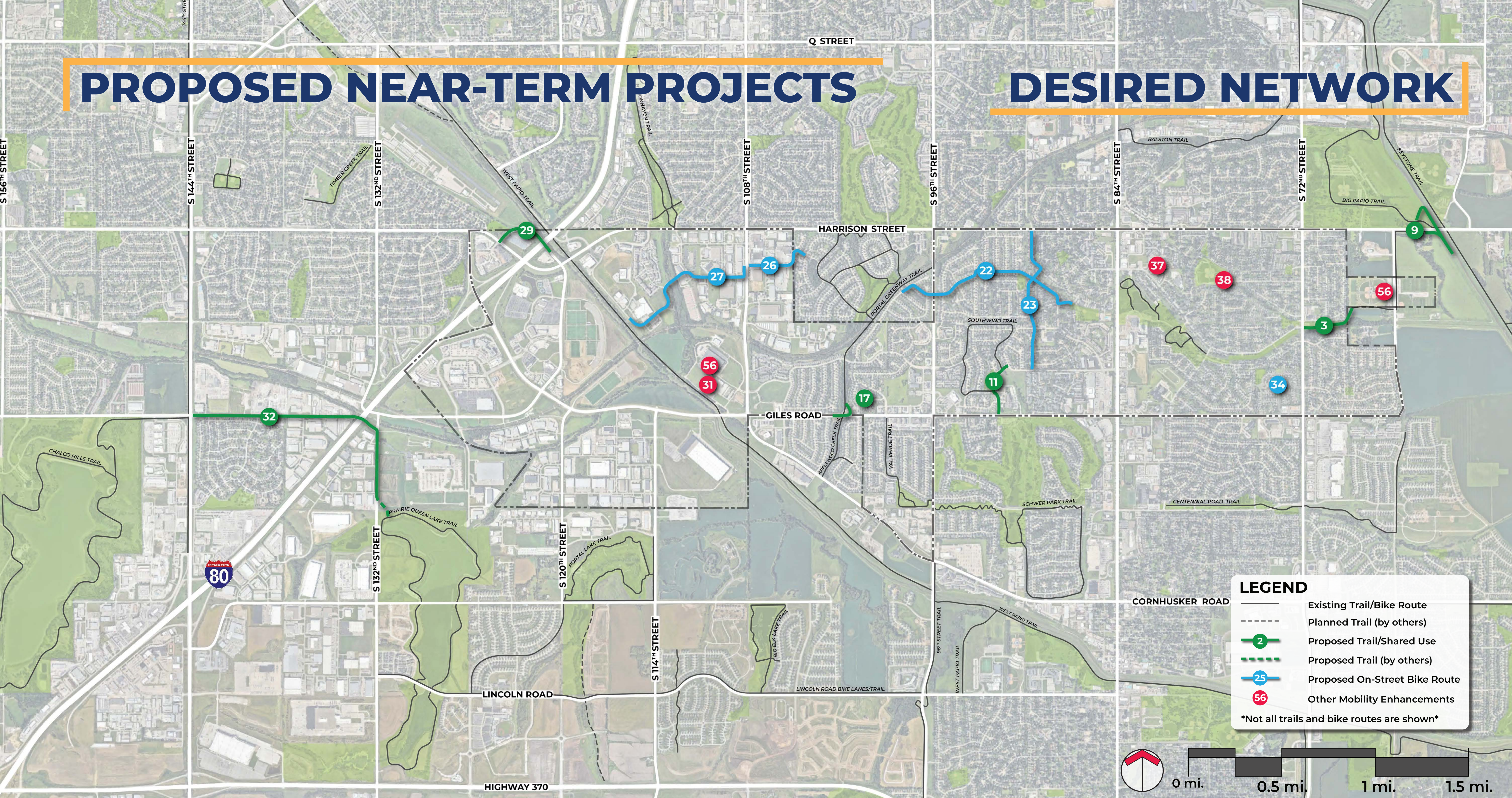

- 3 Mayor's Park Trail from 72nd Street to La Vista Sports Complex
- 9 Grade separated connection from Harrison Street Trail to Big Papio/Keystone Trails
- 11 Shared Use Path/Trail along 92nd Ave and Robin Drive from Brentwood Drive to Giles Road
- 17 Giles Road to Applewood Creek Trail connection on north side
- 29 Shared use path along Eastport Parkway from new West Papio Creek bridge to Harrison Street
- 32 Chalco Hills to Prairie Queen connector

- 22 Valley View Drive bike route, from Portal Greenway Trail to Central Park West
- 23 Elm Drive/Pine Drive bike route from Brentwood Drive to Harrison Street
- 26 Gertrude Street bike route and trail connection to Edna Ave
- 27 Bike route along 118th Street, Olive Street, and Skinner Drive, from West Papio Trail to 108th Street
- 34 Giles Corner Park to Thompson Creek Trail wayfinding signs

- 31 Expanded parking at Harry Andersen and 109th Street trailhead
- 37 Community Center / La Vista West Elementary / City Centre connectivity
- 38 Triangle Park, City Park, Hollis Park connectivity
- 56 Heartland bike share stations at West Papio Trailhead (108th Street) and La Vista Sports Complex (66th Street)

PROPOSED LONG-TERM PROJECTS

ULTIMATE NETWORK

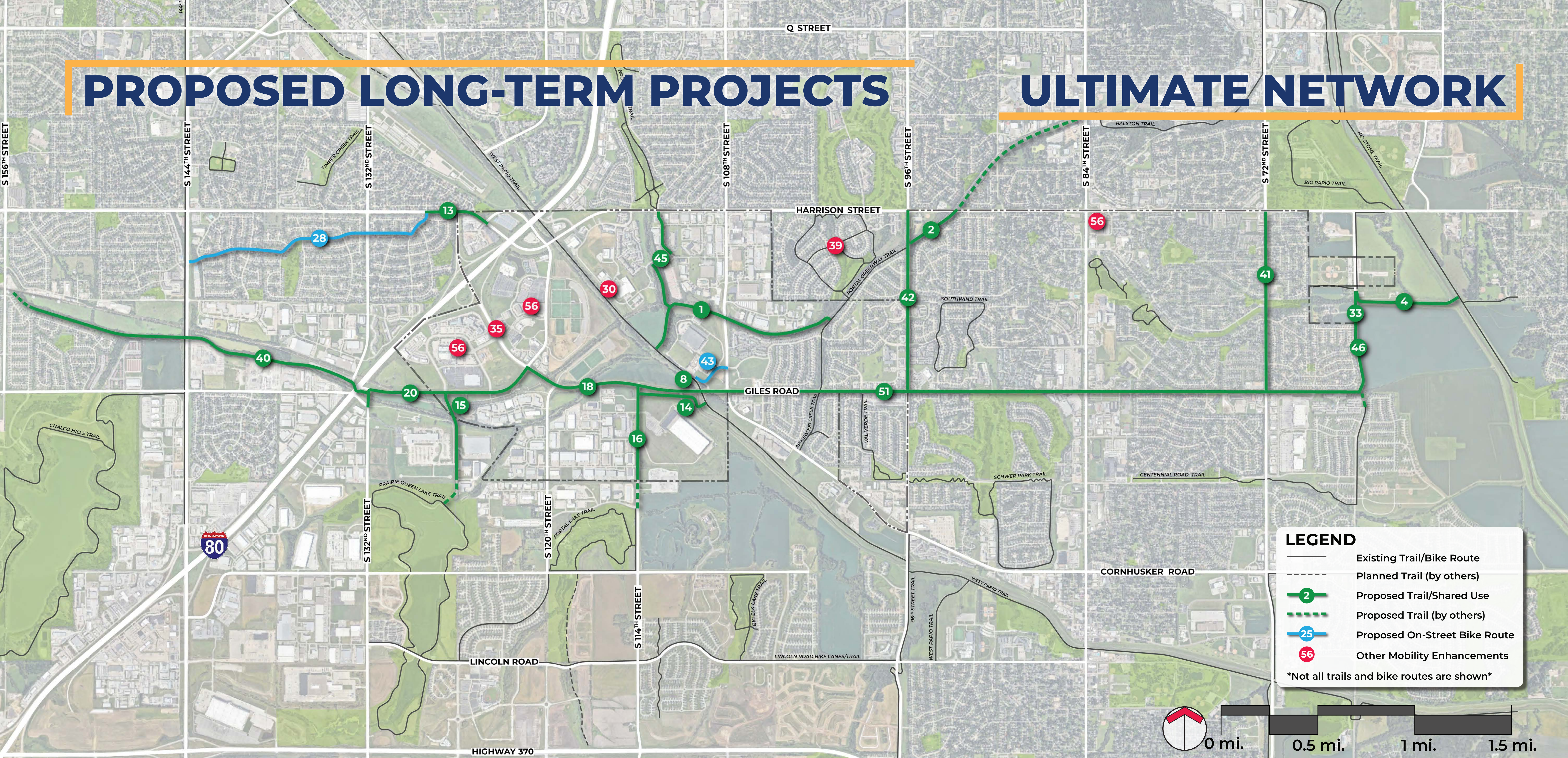

LEGEND

- Existing Trail/Bike Route
- Planned Trail (by others)
- Proposed Trail/Shared Use
- Proposed Trail (by others)
- Proposed On-Street Bike Route
- Other Mobility Enhancements

Not all trails and bike routes are shown

- | | | |
|---|--|--|
| 1 Applewood Creek Trail to West Papio Trail connection | 16 114th Street Trail (west side) from Giles Road to Portal Lake Trail | 46 66th Street Trail connection from Giles to Ardmore East |
| 2 Applewood Creek Trail to Ralston Trail connection | 18 Giles Road Trail/Bikeway | 51 Giles Road Trail (108th to 66th Street, north side) |
| 4 Keystone Trail connection from La Vista Sports Complex | 20 West Giles Road Trail/Bikeway from 132nd Street to Eastport Parkway | 28 On-street bike route from 144th Street to Highland Boulevard along Josephine and Gertrude Streets |
| 8 Giles Road Trail from 114th Street to 108th Street | 33 66th Street Trail connection to Ardmore East | 43 West Papio Trail / Brentwood Drive bike route connection |
| 10 Portal Road crossing and West Papio Trail connection | 40 South Papio Trail (from 132nd to 156th) | 30 Parking/Trailhead along 118th Street near Emiline or Olive |
| 13 Harrison Street Trail connection to Highland Drive | 41 72nd Street trail/sidewalk/shared use path (along east side) | 35 Giles Road and Southport Parkway crossing - grade separation |
| 14 Giles Road Trail (south side) and bridge to West Papio Trail | 42 96th Street trail/sidewalk/shared use path (along either side) | 39 Cimarron Woods (and elsewhere) ADA compliance |
| 15 126th St, Prairie Queen to Costco | 45 Hell Creek Trail from West Papio Trail to Olive Street | 56 Heartland bike share stations - Southport West, Southport East, and at 84th and Harrison |

COMMITTEE UPDATES

Equity & Engagement - Ashley Rae Turner

Housing & Development - Jeff Spiehs

Infrastructure - Mike McIntosh

Natural Resources - Kent Holm



MAPA UPDATES





COUNCIL OF OFFICIALS

HOLIDAY INN

2202 RIVER ROAD
COUNCIL BLUFFS, IA



FEATURED SPEAKER

KEVIN BELLE

PROJECT MANAGER
RAILS TO TRAILS
CONSERVANCY



WEDNESDAY

OCTOBER 9TH, 2024



Register now! tinyurl.com/COOAnnualMtg24



TRAILS WORKSHOP

OCTOBER 9TH, 2024

10 am to 12 pm

ARROWHEAD BREEZY LODGE, NEOLA, IOWA



FEATURED GUEST

KEVIN BELLE

PROJECT MANAGER FOR THE **GREAT AMERICAN RAIL-TRAIL**





NEBRASKA

DEPARTMENT OF ECONOMIC DEVELOPMENT

HOUSING listening sessions

Wednesday, October 23rd

- **9:00 a.m.** (Central Time)
Location: Lincoln – Nebraska Cattlemen, 4611 Cattle Drive, Education Room
- **1:30 p.m.** (Central Time)
Location: Omaha – Omaha Public Library – Benson Branch – 6015 Binney Street

Join the discussion.

The Nebraska Department of Economic Development invites housing stakeholders to a listening session to capture feedback, insight and ideas as they pertain to the agency's Housing Programs.

This is an opportunity to share your housing development perspective and experience to help identify ways in which programs and processes can better address the growing need for affordable housing in Nebraska.

Registration is required to participate.

Click on the following link to register for the session that best fits your location and schedule:

<https://opportunity.nebraska.gov/programs/housing/#registration>.

Registration required by 5 P.M. Central Time on Friday, October 18th.

If you have any questions regarding the upcoming listening sessions, please contact Lynn Kohout at lynn.kohout@nebraska.gov.



Upcoming Training

- Free Training on MUTCD Updates
- The Federal Highway Administration (FHWA) recently updated the MUTCD and states must adopt the updates by January 2026.
- Tuesday, October 22nd, 9 am to 4:30 pm
Council Bluffs Public Library
- **Space is limited!** If you'd like to attend, contact Jim Boerner, MAPA Transportation Planner
jboerner@mapacog.org 402-444-6866 x3231

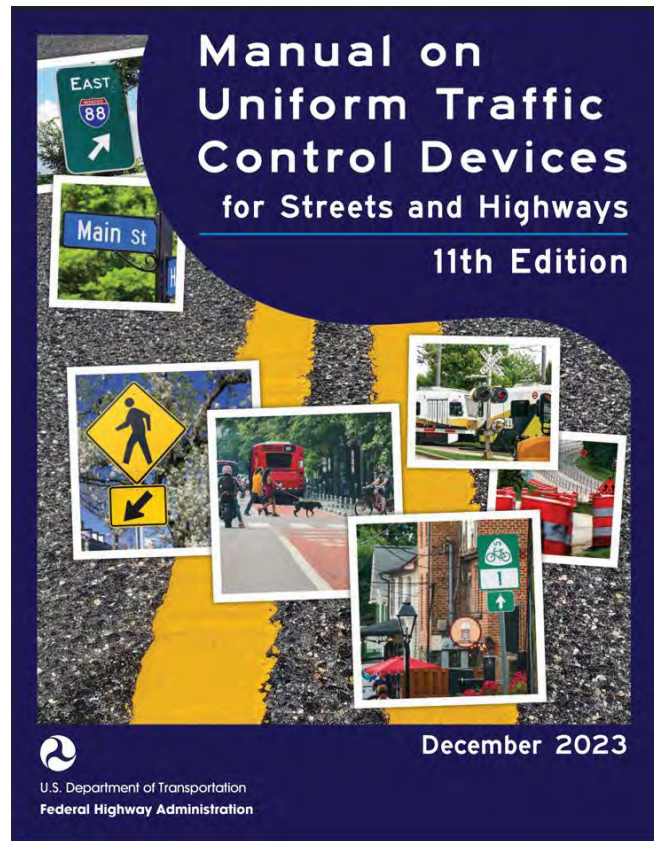

SAFETY SURVEY OPEN NOW

- MAPA is developing a regional Comprehensive Safety Action Plan
 - Improve traffic safety through projects which reduce traffic fatalities and serious injuries on the local road network
 - Douglas and Sarpy Counties in Nebraska, and the cities of Council Bluffs, Carter Lake, Crescent and McClelland in Iowa
- **Community Input Survey Open Now!**
Scan QR code or visit website below

www.mapacog.org/projects/ss4a/

SAFE STREETS
FOR ALL



LONG RANGE TRANSPORTATION SURVEYS OPEN NOW



The **Transportation Management Area (TMA)** covers Douglas, Sarpy and the urbanized portion of Pottawattamie County
<https://lrtp-2050-update.mapacog.org/>

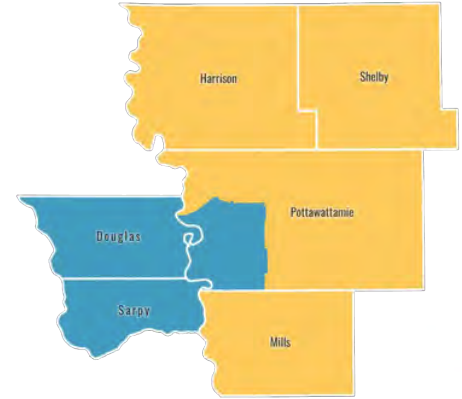

Regional Planning Affiliation 18 (RPA-18) covers Harrison, Shelby, Mills and the non-urban portion of Pottawattamie County
www.mapacog.org/projects/rpa18-lrtp/



REGIONAL BROWNFIELDS COALITION GRANT

- EPA opens \$232M for Brownfield Revolving Loan Fund grants
 - Multipurpose, Assessment, RLF, and Cleanup (MARC) Grant
 - A brownfield is any property with potential environmental contamination
 - Revolving Loan Funds (RLF) provide no-interest or low-interest loans for eligible brownfield cleanups, subgrants for cleanups, and other necessary programmatic costs to manage the RLF
- Applications are due by November 14, 2024
- MAPA is working with partners to discuss a potential collaborative regional grant application
- Reach out to MAPA staff if you'd like to learn more!



CIVIL RIGHTS POLICY UPDATE

- Outlines how laws and federal regulations, specifically those prohibiting discrimination, are implemented in MAPA's processes
- Includes MAPA's Title VI Policy as well as the complaint process for both Title VI and ADA
- Updated every three years
 - Planning to open a **comment period on the draft updated policy in November 2024** with the plan approved in January 2025
- www.mapacog.org/about/what-is-mapacog/civil-rights/



APPLICATIONS OPENING SOON FOR FEDERAL TRANSPORTATION FUNDING

- Local units of government including cities, counties and public transit agencies can apply for this funding
- The **Transportation Management Area (TMA)** covers Douglas, Sarpy and the urbanized portion of Pottawattamie County
 - The Urban Area Boundary has recently been updated
 - www.mapacog.org/projects/tip/
- **Regional Planning Affiliation 18 (RPA-18)** covers Harrison, Shelby, Mills and the non-urban portion of Pottawattamie County
 - www.mapacog.org/projects/rpa-18/

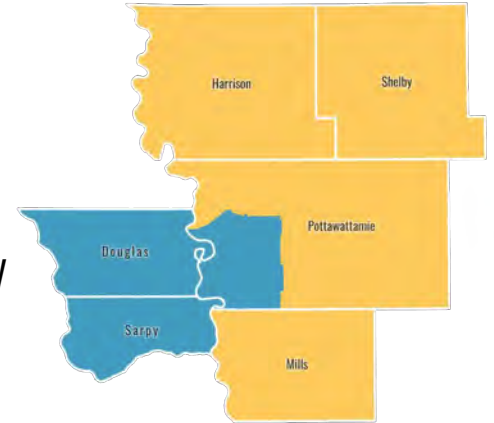

OPEN RFPs/RFQs

- Housing Market Value Analysis RFP
 - Analysis will help establish a baseline of market conditions, benchmark progress and serve as a policy framework
 - Funded through a grant from the Development and Preservation Fund of Front Porch Investments
- On-Call Travel Demand Model RFQ
 - To assist with MAPA's traffic modeling and traffic forecasting activities
- City of Minden, Iowa Housing Developer RFP
 - To submit an application for the 2019 Community Development Block Grant Disaster Recovery – Housing (CDBG-DR) program through the Iowa Economic Development Authority (IEDA)
- View open RFPs/RFQs or join the mailing list at www.mapacog.org/about/rfp-rfq/



MAPA Newsletter Signup

- MAPA sends an electronic newsletter via email every other month
- To join the email list, fill out the form at www.heartland2050.org/contact/ and check the email newsletter box, or contact any MAPA staff member!



COMMUNITY UPDATES



PUBLIC COMMENT



UPCOMING EVENTS

Council of Officials Annual Meeting

October 9, 2024

RPAC Meeting

December 6, 2024

