

**DATE:** August 16, 2016

**TO:** Transportation Technical Advisory Committee (TTAC)

**FROM:** Dennis Wilson, Chairman  
Greg Youell, MAPA Executive Director

**RE:** August 19, 2016 TTAC Meeting

The MAPA TTAC will meet Friday, August 19, 2016 at 10:00 a.m. in the Metro Building at 2222 Cuming Street, Omaha, Nebraska 68102. The TTAC meeting will be held in the Metro Training Room on the lower level. Please enter the building through Metro's front door and follow the signs to the Metro Training Room on the lower level. The agenda item materials can be accessed by clicking on the linked agenda item titles. The agenda is also available at the MAPA offices and online at <http://www.mapacog.org/boards-and-committees/58-agendas>.

### **AGENDA**

#### **For TTAC Approval/Review**

- A. Meeting Minutes – The committee will consider approval of the July 22, 2016 TTAC meeting minutes. (Action Item) (Attachment)

#### **Recommendations to the Board**

- B. FY 2016-2019 Transportation Improvement Program (TIP) Amendments – Staff will present various amendments to the FY 2016-2019 TIP from local jurisdictions and request a recommendation for Board approval. (Action Item) (Attachment)
- C. 2040 Long Range Transportation Plan Amendment - Staff will request a recommendation for approval of an amendment to the LRTP for the adjustment of several NDOR projects. (Action Item) (Attachment)
- D. 2040 Long Range Transportation Plan Amendment - Staff will request a recommendation for approval of an amendment to the LRTP for the adjustment of a City of Omaha project. (Action Item)

#### **Discussion Items**

- E. Funding Obligation and Project Status – Staff will review the annual funding obligation and project status. (Information Item) (Attachment)
- F. Heartland 2050 Funding Allocation - Staff will present progress of the Heartland 2050 mini grant program using STP allocation and ask for consensus on the process. (information item)
- G. 2050 Long-Range Transportation Plan (LRTP) – Staff will present scenario 7 from MTIS and have a discussion on the criteria to be used in the LRTP project selection (Information Item) (Attachment)
- H. Member Agencies Updates – Agencies will present updates for on-going and future project and program across the region. (information Item)
- I. Additional Business  
Upcoming Meetings: Board of Directors- 8/30, Coordinated Transit Committee- 9/14, TTAC- 9/23
- J. Adjournment

Auxiliary aids, language assistance, and services are available when requested in advance, please call the office.  
Si necesita ayuda con traducción, por favor llame la oficina.

# Agenda Item A

## Meeting Minutes

OMAHA-COUNCIL BLUFFS METROPOLITAN AREA PLANNING AGENCY  
Transportation Technical Advisory Committee  
Minutes of July 22, 2016 Meeting

The Transportation Technical Advisory Committee met on Friday, July 22, 2016, at Metro, 2222 Cuming Street, Omaha, Nebraska. Mr. Todd Pfitzer opened the meeting at 10:00 a.m.

VOTING MEMBERS

Denny Wilson	Sarpy County Public Works
Janet McCartney	Cass County
Greg Reeder	City of Council Bluffs Public Works
Jeff Roberts	City of Bellevue Public Works
Dan Giittinger	City of Gretna Development Services
John Kottmann	City of La Vista Public Works
Derek Miller	City of Omaha Planning
Bob Stubbe	City of Omaha Public Works
Todd Pfitzer	City of Omaha Public Works
Tim Weander	Nebraska Department of Roads – District 2
Brad Zumwalt	Nebraska Department of Roads – Lincoln
Eric Williams	Papio-Missouri River NRD
Curt Simon	Metro Transit

NON-VOTING MEMBERS

Greg Youell	Metropolitan Area Planning Agency
Bill Herr	Sarpy County Public Works
Maurice Hinchey	Nebraska Department of Roads – District 2

GUESTS

Lee Myers	AARP
Kyle Kovar	3M Traffic
Stephen Osberg	City of Omaha Planning
Larry Legg	Nebraska Department of Roads – Lincoln
Jim Kollbaum	AECOM
Jeff Lamontagne	AECOM
Jason Carbee	HDR, Inc.
Arobindu Das	Iteris, Inc.
Shane Swope	The Schemmer Associates
Ernest Wesolowski	Citizen

STAFF

Michael Felschow	Metropolitan Area Planning Agency
Court Barber	Metropolitan Area Planning Agency
Mike Helgerson	Metropolitan Area Planning Agency

A. Approval of Minutes

Motion #1: Approval of the minutes of the June 24, 2016 Transportation Technical Advisory Committee Meeting with the revision of Bill Herr as a Voting Member in the attendance

Motion by: Todd Pfitzer  
Second by: Greg Reeder  
Motion Carried

B. FY 2016 – 2019 Transportation Improvement Program (TIP) Amendments

Mr. Helgerson presented the TIP's Amendment 13 to the TTAC. Engineering estimates have changed on the project as well as a description update. This is a project for Eastern Hills Drive in Council Bluffs.

Motion #2: Seeking approval of the MAPA Board of Directors at their July 28, 2016 meeting of the Transportation Improvement Program Amendment 13.

Motion by: Bob Stubbe  
Second by: Greg Reeder  
Motion Carried

C. 2040 Long Range Transportation Plan (LRTP) Amendment

Mr. Helgeson told the TTAC they are bringing the LRTP into consistency with the latest TIP. There are several NDOR projects that have increased by more than 20% or \$2,000,000 from FY 2016 to FY 2017 and included is an additional project that had not been included in the FY 2016 TIP. The projects are:

- Elkhorn River West
- Ralston Viaduct
- N-31: Schramm Park – US-6
- I-680: Mormon Bridge Painting
- US-75 Bridge Approaches, Bellevue
- I-80: I-480 to 24<sup>th</sup> Street
- US-6 Bridges at I-680
- Q Street Bridge
- I-680/US-6 Bridge

Motion #3: Seeking approval of the MAPA Board of Directors at their July 28, 2016 meeting of the 2040 Long Range Transportation Plan Amendment 3.

Motion by: Tim Weander  
Second by: Greg Reeder  
Motion Carried

D. Unified Planning Work Program (UPWP) FY 2017 Amendment

Mr. Felschow presented an Amendment of the FY 2017 UPWP. The Nebraska Board of Ethanol is purchasing four hand-held air ozone monitors that will help improve communicating with the public regarding outreach and ozone education in the region. This is a local match against the Air Quality / Environmental (450) category and there will be no change in the budget.

Motion #4: Seeking approval of the MAPA Board of Directors at their July 28, 2016 meeting of the Unified Planning Work Program FY 2017 Amendment.

Motion by: Curt Simon  
Second by: Eric Williams  
Motion Carried

E. Funding Obligation and Project Status

Mr. Felschow told the TTAC there has been little obligated in terms of the STP Nebraska. In working with NDOR, the FY 2017 TIP has been approved so much of the money has already been assumed to have been transferred to FY 2017 and looking at a total of \$2million forecasted by the end of the fiscal year. The remaining dollars transferred to FY 2017 have not been obligated. TAP funds are "tapped out" with no balance. On the Iowa side, no money has been obligated and for STP based on the TIP, there will be a full carryover of the funding for the year. For TAP, funding of \$566,000 will be done this year.

Nothing has changed in the TIP with being fiscally constraint.

Mr. Felschow said there is much PE work being done which should lead to FY 2017 and FY 2018 being very good construction years.

#### F. 2050 Long Range Transportation Plan (LRTP)

Mr. Felschow said work is being done on the 2050 Long Range Transportation Plan. Discussion included the weight being used in the Goal Areas as considered by Metro Travel Improvement Study (MTIS). These categories include Congestion Reduction, Mobility and Access, Stewardship and Environment and Safety. The weight percentages were negotiated and coordinated considering the present and future needs by MTIS, NDOR and MAPA. When analyzing data from the public, it leans more toward mobility whereas government employees and engineers lean towards congestion. Mobility and Access is a key to project selection. For MTIS, this will be a need / vision plan. Mr. Weander said the purpose of the study is to determine what's needed next with the Interstate system in the metro area along with improving the arterial system and including the state highways to make everything function together.

Mr. Felschow said what's being done is performing additional analysis and looking at the highway systems. Next is prioritizing corridors with the third level analyzing all of the corridors/roadways that are not on either of those two lists such as Blondo Street but still need to be improved. Information is still being gathered from all three counties and communities on projects that are missing from the MTIS scenario list and then they'll work through the next level to a project list.

After completing discussion of the different Alternative Scoring categories, Mr. Felschow asked the TTAC Committee members to respond back with written comments as another part of the process of working through the 2050 LRTP process.

#### G. Member Agencies Updates

- Mr. Weander said the Build Nebraska Act outreach included discussion of the highway system. Omaha's meeting was very successful with 85 in attendance. All of the information given in the La Vista meeting by the attendees is now being compiled by NDOR with a list of selected projects being made this fall.
- Mr. Kottmann said La Vista will have their comprehensive plan update in the next couple of months. The 84<sup>th</sup> Street redevelopment is underway.
- Mr. Simon said negotiations are ongoing with CNG stations.
- Ms. McCartney said Cass County is working on gravel road issues and the county is purchasing a CNG truck.
- Mr. Pfitzer said 32<sup>nd</sup> Avenue work is done; the 42<sup>nd</sup> and Q roundabout is about a month behind but is now on pace; and the westbound closure remains west of 192<sup>nd</sup> and Pacific on Pacific as work continues.
- Mr. Stubbe added information on two projects of Omaha's CIP (Capital Improvement Program) and they are 42<sup>nd</sup> and Leavenworth and the intersection of Leavenworth and Saddle Creek.
- Mr. Pfitzer said they're getting ready to announce the selection of the traffic signal master plan for the master control system.
- Mr. Weander commented on the Fairview Road project in Sarpy County.
- Mr. Reeder said six IDOT maintenance facilities have been closed in Iowa due to lack of funding.

#### H. Additional Business

Mr. Youell passed out to the TTAC information regarding H2050's summer Summit on August 2<sup>nd</sup> at the Harper Center on the Creighton campus with Jeff Speck as the keynote speaker.

#### I. Adjournment

The meeting was adjourned at 11:10 a.m.

Agenda Item B  
FY 2016-2019 Transportation  
Improvement Program (TIP)  
Amendments



# Metropolitan Area Planning Agency FY2016-2021 Transportation Improvement Program

## Revision Summary - Amendment 14

<u>Control #</u> NE-22203	<u>Project Name</u> Ralston Viaduct	<u>Lead Agency</u> NDOR	<u>Revision Note</u> Program \$260,000 of State- Nebraska funding in FY2016 for ROW and increase NHPP funding for UTIL-CON-CE in FY2016 to \$7,840,000
<u>Control #</u> NE-22532	<u>Project Name</u> Elkhorn River West	<u>Lead Agency</u> NDOR	<u>Revision Note</u> Program \$201,000 of State-Nebraska funding in FY2016 for ROW and increase STP-State funding in FY2017 to \$3,898,000 for UTIL-CON-CE
<u>Control #</u> NE-22567	<u>Project Name</u> N-31: Schramm Park - US-6	<u>Lead Agency</u> NDOR	<u>Revision Note</u> Reprogram \$55,000 of State-Nebraska funding to FY2017 for PE-NEPA-FD, program \$40,000 of State-Nebraska funding in FY2017 for ROW, and reprogram UTIL-CON-CE phase to FY2018 and increase STP-State funding to \$3,994,000
<u>Control #</u> NE-22632	<u>Project Name</u> I-680: Mormon Bridge Painting	<u>Lead Agency</u> NDOR	<u>Revision Note</u> Decrease FY2018 NHPP funding to \$5,236,000 for UTIL-CON-CE and program \$6,584,000 of State-Iowa funding in FY2018 for UTIL-CON-CE
<u>Control #</u> NE-22646	<u>Project Name</u> I-80: I-480 to 24th Street	<u>Lead Agency</u> NDOR	<u>Revision Note</u> Increase State-Nebraska funding for PE-NEPA-FD to \$215,000 in FY2016 and reprogram \$6,547,000 of State-Nebraska funding in FY2017 for UTIL-CON-CE
<u>Control #</u> NE-22593	<u>Project Name</u> I-680 / US-6 Bridges	<u>Lead Agency</u> NDOR	<u>Revision Note</u> Reprogram \$295,000 of State-Nebraska funding from FY2016 to FY2020 and decrease FY2021 NHPP funding to \$3,065,000 for UTIL-CON-CE
<u>Control #</u> NE-22634	<u>Project Name</u> US-75 Bridge Approaches, Bellevue	<u>Lead Agency</u> NDOR	<u>Revision Note</u> Reprogram \$1,000 of State-Nebraska funding to FY2017 for PE-NEPA-FD and decrease FY2017 NHPP funding to \$1,314,000 for UTIL-CON-CE
<u>Control #</u> NE-22605	<u>Project Name</u> 2014 Omaha Resurfacing Package	<u>Lead Agency</u> Omaha	<u>Revision Note</u> Increase FY2016 AC-Conversion to STP-MAPA to \$1,935,000 and reduce FY2021 AC-Conversion to STP-MAPA to \$1,378,000



# Metropolitan Area Planning Agency FY2016-2021 Transportation Improvement Program

TIP ID <b>2015-037</b>		Project Name <b>Ralston Viaduct</b>	
Control Number <b>NE-22203</b>			
Lead Agency <b>NDOR</b>	Project Type <b>Bridge</b>		
County <b>Douglas</b>	Length (mi)	Total Project Cost*	<b>\$10,505.00</b>
Location <b>N-85/BNSF viaduct in Ralston. Begin R.P. – 4.02</b>			
Description Replacement of existing viaduct over BNSF railroad in Ralston and associated approach work. Local funding contributed to the project by Ralston and Omaha			

Fiscal Year	Project Phase	Funding Source	Total Funds*	Federal Funds*	State Funds*	Local Funds*
2014	PE-NEPA-FD	State-Nebraska	\$380.00	\$0.00	\$304.00	\$76.00
2016	ROW	NHPP	\$325.00	\$0.00	\$260.00	\$65.00
2016	UTIL-CON-CE	NHPP	\$9,800.00	\$7,840.00	\$0.00	\$1,960.00

\* Amounts in thousands of U.S. dollars

## Revision History

**8/30/2016**

**Amendment 14**

Program \$260,000 of State- Nebraska funding in FY2016 for ROW and increase NHPP funding for UTIL-CON-CE in FY2016 to \$7,840,000

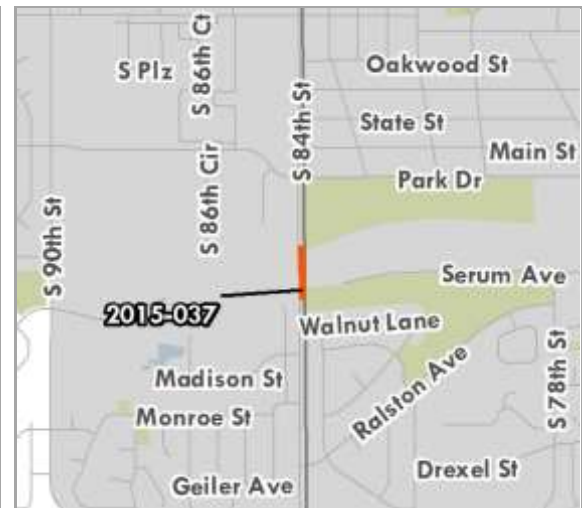





# Metropolitan Area Planning Agency FY2016-2021 Transportation Improvement Program

TIP ID <b>2015-028</b>		Project Name <b>Elkhorn River West</b>	
Control Number <b>NE-22532</b>			
Lead Agency	<b>NDOR</b>	Project Type	<b>Resurfacing</b>
County	<b>Douglas</b>	Length (mi)	<b>6.40</b>
		Total Project Cost*	<b>\$5,234.00</b>
Location <b>On N-36 from Old Highway 275/Reicmuth Road, east to just west of the Elkhorn River</b>			
Description <b>Concrete repair, mill, resurface, repair 2 bridges, replace 1 bridge</b>			

Fiscal Year	Project Phase	Funding Source	Total Funds*	Federal Funds*	State Funds*	Local Funds*
2016	PE-NEPA-FD	State-Nebraska	\$201.00	\$0.00	\$201.00	\$0.00
2016	ROW	State-Nebraska	\$10.00	\$0.00	\$10.00	\$0.00
2017	UTIL-CON-CE	STP-State	\$5,023.00	\$3,898.00	\$1,125.00	\$0.00

\* Amounts in thousands of U.S. dollars

## Revision History

**8/30/2016**

**Amendment 14**

Program \$201,000 of State-Nebraska funding in FY2016 for ROW and increase STP-State funding in FY2017 to \$3,898,000 for UTIL-CON-CE

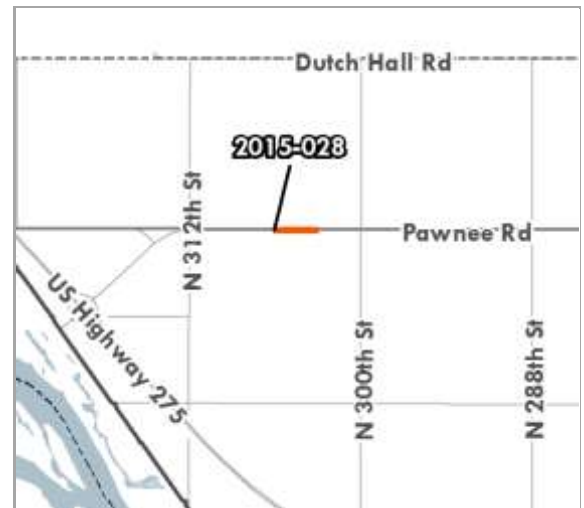



# Metropolitan Area Planning Agency FY2016-2021 Transportation Improvement Program

TIP ID		Project Name	
2016-002		<b>N-31: Schramm Park - US-6</b>	
Control Number			
NE-22567			
Lead Agency	NDOR	Project Type	Resurfacing
County	Sarpy	Length (mi)	5.40
		Total Project Cost*	\$5,088.00
Location			
On N-31 from near Schramm Park entrance to south junction with US-6			
Description			
Rehabilitate concrete pavement and reconstruct bridge approach slabs			

Fiscal Year	Project Phase	Funding Source	Total Funds*	Federal Funds*	State Funds*	Local Funds*
2017	PE-NEPA-FD	State-Nebraska	\$55.00	\$0.00	\$55.00	\$0.00
2017	ROW	State-Nebraska	\$40.00	\$0.00	\$40.00	\$0.00
2018	UTIL-CON-CE	STP-State	\$4,993.00	\$3,994.00	\$999.00	\$0.00

\* Amounts in thousands of U.S. dollars

## Revision History

**8/30/2016**

**Amendment 14**

Reprogram \$55,000 of State-Nebraska funding to FY2017 for PE-NEPA-FD, program \$40,000 of State-Nebraska funding in FY2017 for ROW, and reprogram UTIL-CON-CE phase to FY2018 and increase STP-State funding to \$3,994,000





# Metropolitan Area Planning Agency FY2016-2021 Transportation Improvement Program

TIP ID <b>2016-020</b>		Project Name <b>I-680: Mormon Bridge Painting</b>	
Control Number <b>NE-22632</b>			
Lead Agency	<b>NDOR</b>	Project Type	<b>Bridge</b>
County	<b>Douglas</b>	Length (mi)	
		Total Project Cost*	<b>\$12,412.00</b>
Location <b>On I-680 at Mormon Bridge over Missouri River. Begin R.P. – 13.43</b>			
Description <b>Bridge painting</b>			

Fiscal Year	Project Phase	Funding Source	Total Funds*	Federal Funds*	State Funds*	Local Funds*
2016	PE-NEPA-FD	State-Nebraska	\$10.00	\$0.00	\$10.00	\$0.00
2018	UTIL-CON-CE	State-Iowa	\$6,584.00	\$0.00	\$6,584.00	\$0.00
2018	UTIL-CON-CE	NHPP	\$5,818.00	\$5,236.00	\$582.00	\$0.00

\* Amounts in thousands of U.S. dollars

## Revision History

**8/30/2016**

**Amendment 14**

Decrease FY2018 NHPP funding to \$5,236,000 for UTIL-CON-CE and program  
\$6,584,000 of State-Iowa funding in FY2018 for UTIL-CON-CE





# Metropolitan Area Planning Agency FY2016-2021 Transportation Improvement Program

TIP ID		Project Name	
2016-026		I-80: I-480 to 24th Street	
Control Number			
NE-22646			
Lead Agency	NDOR	Project Type	Resurfacing
County	Douglas	Length (mi)	0.30
		Total Project Cost*	\$6,762.00
Location			
On I-80 from I-480 to 24th Street. Begin R.P. – 453.01			
Description			
Mill, inlay, and restripe for three-lane section			

Fiscal Year	Project Phase	Funding Source	Total Funds*	Federal Funds*	State Funds*	Local Funds*
2016	PE-NEPA-FD	State-Nebraska	\$215.00	\$0.00	\$215.00	\$0.00
2017	UTIL-CON-CE	State-Nebraska	\$6,547.00	\$0.00	\$6,547.00	\$0.00

\* Amounts in thousands of U.S. dollars

## Revision History

8/30/2016

Amendment 14

Increase State-Nebraska funding for PE-NEPA-FD to \$215,000 in FY2016 and reprogram \$6,547,000 of State-Nebraska funding in FY2017 for UTIL-CON-CE

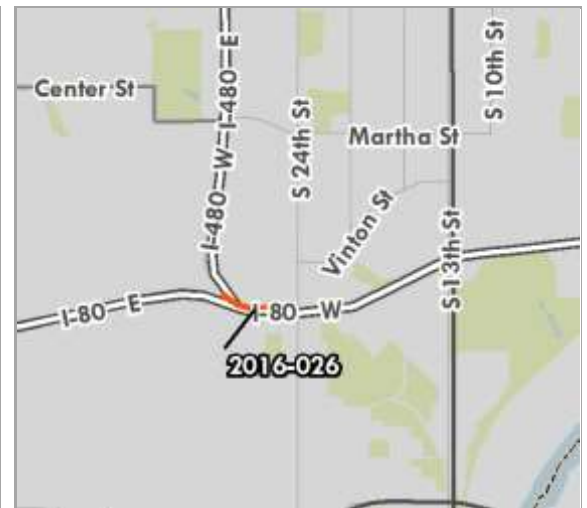



# Metropolitan Area Planning Agency FY2016-2021 Transportation Improvement Program

TIP ID 2015-152		Project Name <b>I-680 / US-6 Bridges</b>	
Control Number NE-22593			
Lead Agency	NDOR	Project Type	Bridge
County	Douglas	Length (mi)	
		Total Project Cost*	\$3,700.00
Location On I-680 at US-6. Begin R.P. – 2.89			
Description High friction surface course on bridges over I-680			

Fiscal Year	Project Phase	Funding Source	Total Funds*	Federal Funds*	State Funds*	Local Funds*
2020	PE-NEPA-FD	State-Nebraska	\$295.00	\$0.00	\$295.00	\$0.00
2021	PE-NEPA-FD	NHPP	\$3,405.00	\$3,065.00	\$340.00	\$0.00

\* Amounts in thousands of U.S. dollars

## Revision History

**8/30/2016**

**Amendment 14**

Reprogram \$295,000 of State-Nebraska funding from FY2016 to FY2020 and decrease FY2021 NHPP funding to \$3,065,000 for UTIL-CON-CE

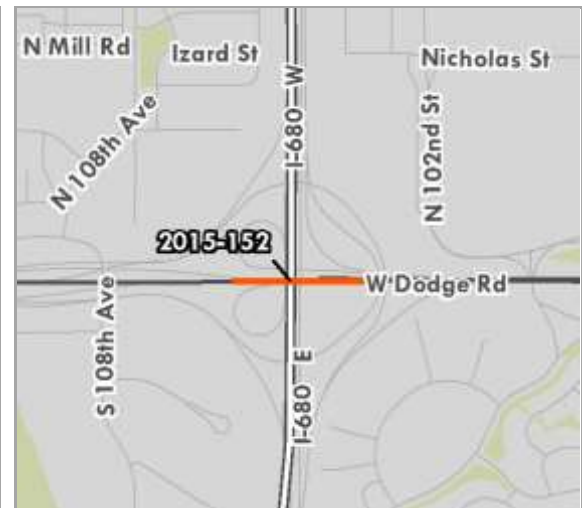

TIP ID		Project Name	
2016-022		US-75 Bridge Approaches, Bellevue	
Control Number			
NE-22634			
Lead Agency	NDOR	Project Type	Bridge
County	Sarpy	Length (mi)	0.90
		Total Project Cost*	\$1,643.00
Location			
US-75 bridges approaches from approximately 0.3 miles south Bellevue, north to Chandler Road. Begin R.P. – 80.03			
Description			
Rebuild seventeen (17) bridge approach slabs			

Fiscal Year	Project Phase	Funding Source	Total Funds*	Federal Funds*	State Funds*	Local Funds*
2017	PE-NEPA-FD	State-Nebraska	\$1.00	\$0.00	\$1.00	\$0.00
2018	UTIL-CON-CE	NHPP	\$1,642.00	\$1,314.00	\$328.00	\$0.00

\* Amounts in thousands of U.S. dollars

## Revision History

8/30/2016

### Amendment 14

Reprogram \$1,000 of State-Nebraska funding to FY2017 for PE-NEPA-FD and decrease FY2017 NHPP funding to \$1,314,000 for UTIL-CON-CE

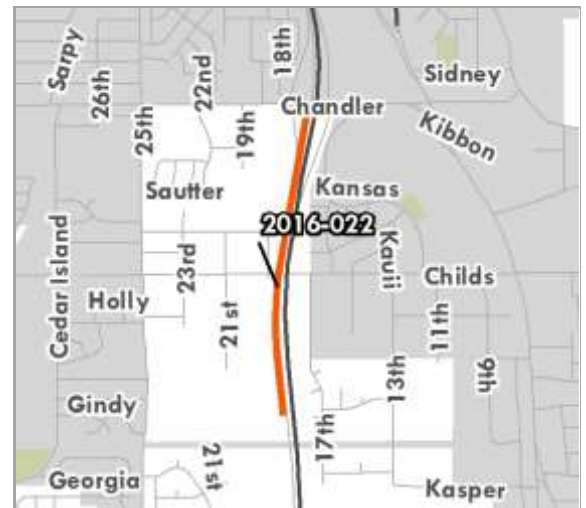



# Metropolitan Area Planning Agency FY2016-2021 Transportation Improvement Program

TIP ID <b>2015-019</b>		Project Name <b>2014 Omaha Resurfacing Package</b>	
Control Number <b>NE-22605</b>			
Lead Agency	<b>Omaha</b>	Project Type	<b>Resurfacing</b>
County	<b>Douglas</b>	Length (mi)	<b>0.00</b>
		Total Project Cost*	<b>\$8,010.96</b>
Location <b>Various locations</b>			
Description Package of resurfacing projects on eligible Federal-aid roadways.			

Fiscal Year	Project Phase	Funding Source	Total Funds*	Federal Funds*	State Funds*	Local Funds*
2014	3. UTIL-CON-CE	Local	\$828.19	\$0.00	\$0.00	\$828.19
2014	3. UTIL-CON-CE (AC)	Local	\$3,312.77	\$0.00	\$0.00	\$3,312.77
2016	3. UTIL-CON-CE	STP-MAPA	\$0.00	\$1,935.00	\$0.00	(\$1,935.00)
2021	3. UTIL-CON-CE	STP-MAPA	\$0.00	\$1,377.77	\$0.00	(\$1,377.77)

\* Amounts in thousands of U.S. dollars

## Revision History

**10/29/2015**

### Amendment 1

Program \$735,000 of AC Conversion in FY2016 and reduce AC Conversion in 2021 to \$2,577,770

**8/30/2016**

### Amendment 14

Increase FY2016 AC-Conversion to STP-MAPA to \$1,935,000 and reduce FY2021 AC-Conversion to STP-MAPA to \$1,378,000



Agenda Item C  
Long Range Transportation Plan  
Amendment



# 2040 LRTP AMENDMENT

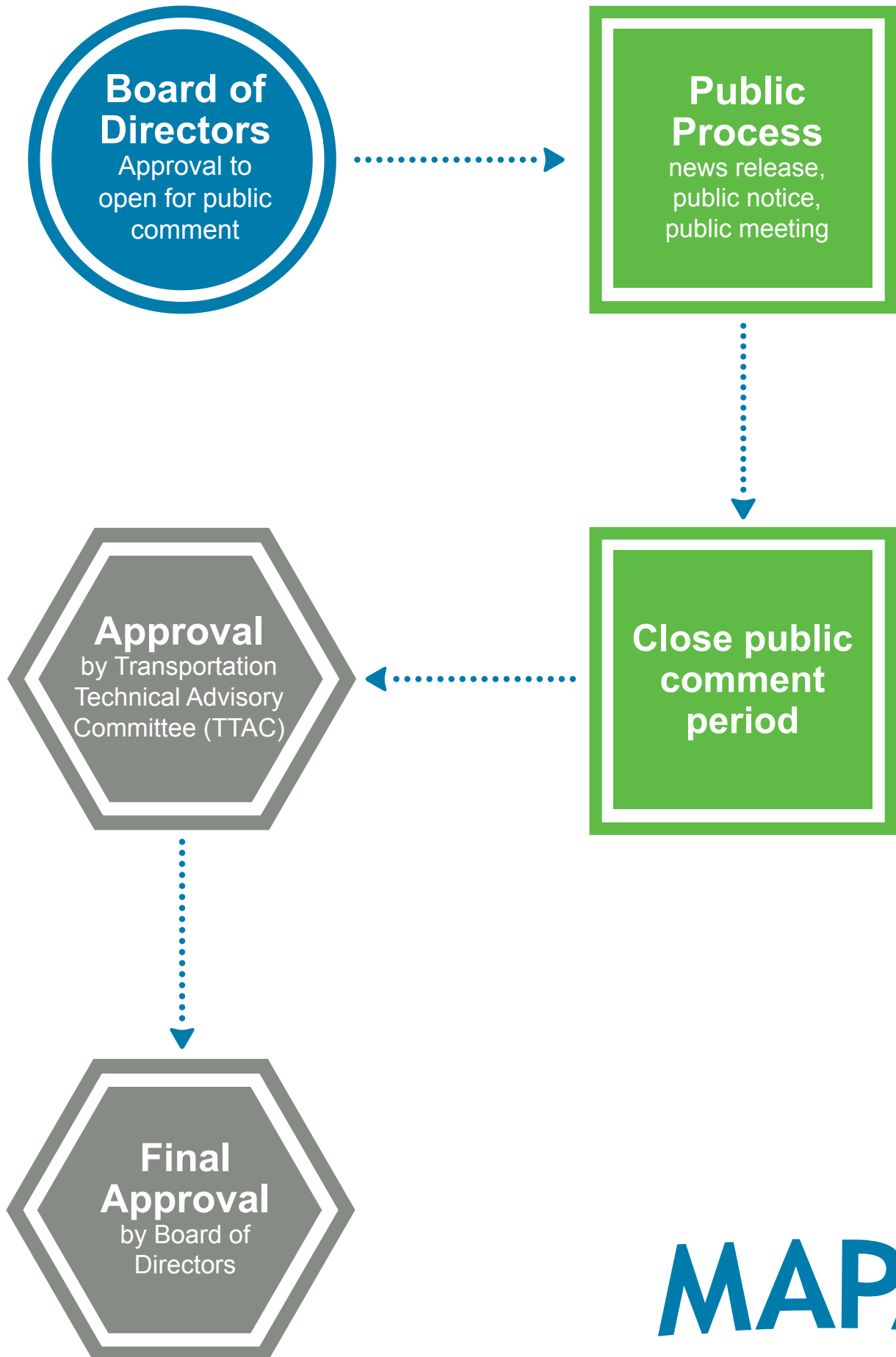

Metropolitan Area Planning Agency

## Long Range Transportation Plan 2040

**TABLE 7.1**  
**ANTICIPATED FEDERAL REVENUES**

**Nebraska Federal Highway Administration (FHWA) Revenues (in \$1,000s)**

Funding Category	Annual Average	2016-2019 (TIP)	2020-2025	2026-2030	2031-2035	2036-2040	Total
CMAQ	\$750	\$1,930	\$4,997	\$4,897	\$5,044	\$5,195	<b>\$22,063</b>
DPU	\$1,000	\$4,360	\$0	\$0	\$0	\$0	<b>\$4,360</b>
HSIP	\$1,600	\$6,248	\$10,660	\$10,447	\$10,761	\$11,084	<b>\$49,200</b>
NHPP	\$18,500	<b>\$75,589</b>	<b>\$3,065</b>	\$0	\$0	\$0	<b>\$78,654</b>
STP-MAPA	\$15,071	<b>\$101,169</b>	\$100,410	\$98,407	\$101,359	\$104,400	<b>\$505,745</b>
STP-HBP	\$1,000	\$5,000	\$6,662	\$6,530	\$6,725	\$6,927	<b>\$31,844</b>
STP-State	\$2,500	<b>\$13,183</b>	\$0	\$0	\$0	\$0	<b>\$13,183</b>
TAP-MAPA	\$1,000	\$4,730	\$6,662	\$6,530	\$6,725	\$6,927	<b>\$31,574</b>
<b>Total</b>	<b>\$41,421</b>	<b>\$212,209</b>	<b>\$132,456</b>	<b>\$126,811</b>	<b>\$130,614</b>	<b>\$134,533</b>	<b>\$736,623</b>

**Iowa Federal Highway Administration (FHWA) Revenues (in \$1,000s)**

Funding Category	Annual Average	2016-2019 (TIP)	2020-2025	2026-2030	2031-2035	2036-2040	Total
CMAQ	\$150	\$864	\$946	\$879	\$897	\$915	<b>\$4,501</b>
DPS	\$1,150	\$4,662	\$0	\$0	\$0	\$0	<b>\$4,662</b>
NHPP	\$98,000	\$388,309	\$84,681	\$0	\$0	\$0	<b>\$472,990</b>
STP-MAPA	\$1,700	\$15,600	\$10,724	\$9,963	\$10,162	\$10,366	<b>\$56,815</b>
STP-HBP	\$2,700	\$0	\$6,308	\$5,861	\$5,978	\$6,097	<b>\$24,244</b>
STP-State	\$5,000	\$0	\$6,557	\$18,400	\$0	\$0	<b>\$24,957</b>
TAP-MAPA	\$300	\$700	\$1,892	\$1,758	\$1,793	\$1,829	<b>\$7,972</b>
<b>Total</b>	<b>\$109,000</b>	<b>\$410,135</b>	<b>\$111,108</b>	<b>\$36,861</b>	<b>\$18,830</b>	<b>\$19,207</b>	<b>\$596,141</b>

**Total Regional Federal Highway Administration (FHWA) Revenues (in \$1,000s)**

Funding Category	Annual Average	2016-2019 (TIP)	2020-2025	2026-2030	2031-2035	2036-2040	Total
CMAQ	\$900	\$2,794	\$5,943	\$5,776	\$5,941	\$6,110	\$26,564
DPS & DPU	\$2,150	\$9,022	\$0	\$0	\$0	\$0	\$9,022
HSIP	\$1,600	\$6,248	\$10,660	\$10,447	\$10,761	\$11,084	\$49,200
NHPP	\$116,500	<b>\$463,898</b>	<b>\$87,746</b>	\$0	\$0	\$0	<b>\$551,644</b>
STP-MAPA	\$16,771	<b>\$116,769</b>	\$111,134	\$108,370	\$111,521	\$114,766	<b>\$562,560</b>
STP-HBP	\$3,700	\$5,000	\$12,970	\$12,391	\$12,703	\$13,024	\$56,088
STP-State	\$7,500	<b>\$13,183</b>	\$6,557	\$18,400	\$0	\$0	<b>\$38,140</b>
TAP-MAPA	\$1,300	\$5,430	\$8,554	\$8,288	\$8,518	\$8,756	\$39,546
<b>Total</b>	<b>\$150,421</b>	<b>\$622,344</b>	<b>\$243,564</b>	<b>\$163,672</b>	<b>\$149,444</b>	<b>\$153,740</b>	<b>\$1,332,764</b>

## 7.6 REGIONALLY SIGNIFICANT TRANSPORTATION INVESTMENTS

The list of street and highway projects eligible for Federal aid funding following in this section is fiscally-constrained to reasonably available local, state, and federal revenues. Project costs take inflation into account and appear in year-of-expenditure dollars. Therefore, project costs for future years appear higher than what they would cost if constructed today. As is described in Section 7.3, federal funding levels were identified based on past trends within the Omaha-Council Bluffs region. Local revenues were identified based on local financial reports and identified operations & maintenance costs.

These projects listed in this LRTP are considered eligible for Federal-Aid funding by the MPO. Projects will be selected for Federal aid funding as they go through the MPO's project selection and prioritization process for the TIP, while some projects may be advanced using solely local funding sources. The following sections divide the projects between Regionally Significant Roadway & Trail Projects, Regionally Significant Transit Investments, and Illustrative Projects.

### 7.5.1— REGIONALLY SIGNIFICANT ROADWAY & TRAIL INVESTMENTS

The tables that follow this section include regionally significant roadway and trail projects identified from the 2035 Long Range Transportation Plan and the scenario planning process described earlier in this chapter. These investments represent the federal-aid eligible portion of this LRTP as the total funding for both local and state projects has been

The FY2016-2019 Transportation Improvement Program serves as the four-year implementation program of this plan. Projects identified in this TIP are included in the first band of projects within this project list.

A summary of the fiscally constrained Roadway & Trail program is included in Table 7.8 below.

**TABLE 7.8**  
**SUMMARY OF REGIONALLY SIGNIFICANT ROADWAY & TRAIL PROJECTS**

	2016-2019 (TIP)	2020-2025	2026-2030	2031-2035	2036-2040	Total
<b>Iowa</b>	\$467,444	\$120,273	\$37,320	\$59,884	\$35,153	<b>\$720,074</b>
<b>Nebraska</b>	352,104	\$126,460	\$151,710	\$147,222	\$148,488	<b>\$925,984</b>
<b>Total</b>	<b>\$819,548</b>	<b>\$246,733</b>	<b>\$189,030</b>	<b>\$207,106</b>	<b>\$183,641</b>	<b>\$1,646,058</b>

(Figures in \$1,000s)

## Nebraska TIP Projects | FY 2016-2019

TIP ID	Lead Agency	Project Name	Improvement Location	Project Cost (FY2016-2019)	Total Project Cost
2015-048	Bellevue	36th Street Phase N-370 - Sheridan	36th St - N-370 to Sheridan	\$9,618,500	\$10,871,620
2015-050	Bellevue	36th Street Phase II	Sheridan to Platteview Rd	\$956,130	\$9,911,130
2015-046	Bennington	156th Street	Bennington	\$2,208,750	\$2,929,446
2015-039	Douglas	180th Street (Phase 1)	HWS Cleveland Blvd to Blondo St and Blondo St .25 mile East and West to 180th St	\$28,520,000	\$31,185,000
2016-037	La Vista	Applewood Creek Trail	From Giles Road north along Applewood Creek between Giles and Harrison	\$163,000	\$1,830,500
2016-038	MAPA	Heartland B-Cycle Expansion	Various locations throughout the City of Omaha	\$1,162,909	\$1,162,909
2015-021	Metro	Metro Rolling Stock	Metro Transit service area	\$3,052,500	\$4,466,250
2015-139	Metro	Bus Rapid Transit	Along Dodge/Farnham corridor, from Westroads Mall	\$2,232,500	\$36,012,500
2015-005	NDOR	I-680/US-6 Interchange DMS	Along I-680/US-6 in Omaha. Begin R.P. – 2.29	\$712,000	\$760,000
2015-006	NDOR	N-370: US-75 West, Bellevue	N-370 sections from 1.6 mi east of 72nd Street east 3.15 mi	\$5,474,000	\$5,670,000
2015-008	NDOR	I-80/680 'Q'-L' CD Rds, Omaha (WB)	WB I-80 CD roads and ramps in the I-80/I-680 interchange area in Omaha. Begin R.P. – 444.23	\$4,197,000	\$4,237,000
2015-015	NDOR	US-75: Plattsmouth - Bellevue, North of Platte River	US-75 from Platte River bridge, north 3.1 miles. Begin R.P. – 76.30	\$32,016,000	\$32,016,000
2015-023	NDOR	I-80: 24th Street - 13th Street	I-80 from 24th Street to 10th Street. Begin R.P. – 453.37	\$13,446,000	\$13,446,000
2015-024	NDOR	Platte River Bridges East of Yutan	On Highway N-92, two bridges over the Platte River 1.5 and 1.8 miles east of Yutan. Begin R.P. – 462.56	\$947,000	\$962,000
2015-025	NDOR	Schramm Park South	N-31, 4.2 miles south of Schramm Park Recreational Area. Begin R.P. – 4.18	\$1,870,000	\$1,925,000
2015-026	NDOR	Giles Road Interchange Ramps	I-80 ramps at Giles Road interchange. Begin R.P – 442.0	\$2,483,000	\$2,541,000
2015-027	NDOR	Jct N-31/N-36 Intersection Improvements	Junction of Highways N-31 and N-36. Begin R.P. – 30.93	\$2,092,000	\$2,092,000
2015-028	NDOR	Elkhorn River West	On N-36 from Old Highway 275/Reicmuth Road, east to just west of the Elkhorn River	\$5,234,000	\$5,234,000
2015-029	NDOR	N-64 at SE Jct US-275 - Omaha	N-64 (W Maple Road) at junction of US-275 east to Ranglewood Drive/Elkhorn Drive. Begin R.P. – 59.21	\$3,250,000	\$3,360,000
2015-034	NDOR	N-92: Platte River East Structures	Nebraska Highway 92 (W Center Road) at the Platte River. Begin R.P. – 463.30	\$715,000	\$740,000
2015-036	NDOR	EB I-80 at I-680	EB I-80 at interchange with I-680. Begin R.P. – 445.74	\$1,342,000	\$1,342,000
2015-037	NDOR	Ralston Viaduct	N-85/BNF viaduct in Ralston. Begin R.P. – 4.02	\$10,125,000	\$10,505,000
2015-068	NDOR	N-133: Thomas Creek Bridge North (SB)	On southbound lanes of N-133 from just north of Thomas Creek crossing, north 0.12 miles. Begin R.P. – 5.94	\$532,000	\$534,000
2016-001	NDOR	I-480: Bancroft - Dewey	On I-480, from 0.1 miles north of I-80/US-75, north to miles south of Harney Street. Begin R.P. – 0.50	\$6,692,000	\$6,700,000
2016-002	NDOR	N-31: Schramm Park - US-6	On N-31 from near Schramm Park entrance to south junction with US-6	\$5,088,000	\$5,088,000
2016-003	NDOR	US-275: Waterloo Viaduct	On US-275 from Valley to viaduct at Waterloo. Begin R.P. – 165.74	\$7,570,000	\$7,570,000
2016-004	NDOR	US-275: West Papillion Creek Bridge West	On US-275 from 1.6 mile east of the west limits of Omaha to east of West Papillion Creek bridge. Begin R.P. – 176.33	\$1,556,000	\$1,556,000
2016-005	NDOR	I-680: Fort Street to Missouri River	On I-680 from near Fort Street northeast to Missouri River Bridge. Begin R.P. – 6.04	\$155,000	\$155,000
2016-006	NDOR	I-80/I-480 Bridges	I-80 bridges at I-480 Interchange. Begin R.P. – 451.00	\$4,800,000	\$4,800,000
2016-007	NDOR	I-80/I-480/US-75 Interchange	I-80 and I-480 bridges at I-80/I-480/US-75 Interchange. Begin R.P. – 452.98	\$12,970,000	\$12,970,000
2016-008	NDOR	I-480: 20th Street - Missouri River Bridges (EB)	On eastbound I-480 (including ramps) from 20th Street to the Missouri River. Begin R.P. – 2.95	\$8,600,000	\$8,600,000
2016-009	NDOR	I-480: 20th Street - Missouri River Bridges (WB)	On westbound I-480 (including ramps) from 20th Street to the Missouri River. Begin R.P. – 2.95	\$9,350,000	\$9,350,000
2016-010	NDOR	N-31 Bridges North of N-36	On N-31, approximately 0.7 miles and 5.2 miles north of N-36. Begin R.P. – 31.75	\$2,271,000	\$2,271,000
2016-011	NDOR	US-75: J Street & Gilmore Ave Bridge (SB)	Viaduct on US-75 at Gilmore/Union Pacific Rail Road and bridge at J Street. Begin R.P. – 85.80	\$2,619,000	\$2,619,000
2016-012	NDOR	US-75: Off Ramp to N-64 (NB)	On northbound US-75 off-ramp to N-64 (Cumming Street). Begin R.P. – 91.09	\$258,000	\$258,000
2016-013	NDOR	US-75: Big Papillion Creek, Bellevue	On US-75 over Big Papillion Creek, approximately 0.3 miles south of Bellevue. Being R.P. – 80.03	\$250,000	\$250,000
2016-014	NDOR	District 2 CCTV Cameras	On I-680, at three (3) locations in the Omaha area. Begin R.P. – 9.94	\$131,000	\$136,000
2016-015	NDOR	US-75 Fiber-Optic	Along US-75 from Fort Crook Road to south Junction with I-480	\$755,000	\$759,000
2016-016	NDOR	US-6 Fiber-Optic	Along US-6 from N-31 to Westroads Mall Road in Omaha	\$922,000	\$922,000
2016-017	NDOR	I-80/I-480/I-680 Barriers, Omaha	Along I-80, I-480, and I-680 bridge locations in Omaha	\$864,000	\$864,000
2016-018	NDOR	I-80, N-31, N-370, & N-50 Ramps	I-80 interchange ramps at N-31, N-370, and N-50	\$710,000	\$710,000
2016-019	NDOR	US-275: 25th Street - 23rd Street	On US-275 from 1/2 block west of 25th Street to 1/2 block east of 23rd Street. Begin R.P. – 189.14	\$1,668,000	\$1,668,000
2016-020	NDOR	I-680: Mormon Bridge Painting	On I-680 at Mormon Bridge over Missouri River. Begin R.P. – 13.43	\$12,412,000	\$12,412,000
2016-021	NDOR	I-680: Mormon Bridge Deck Overlay	On I-680 at Mormon Bridge over Missouri River. Begin R.P. – 13.43	\$1,610,000	\$1,610,000
2016-022	NDOR	US-75 Bridge Approaches, Bellevue	US-75 bridges approaches from approximately 0.3 miles south Bellevue, north to Chandler Road. Begin R.P. – 80.03	\$1,643,000	\$1,643,000
2016-023	NDOR	24th Street Interstate Bridge	On 24th Street over I-80. Begin R.P. – 453.37	\$460,000	\$460,000
2016-024	NDOR	N-31: Elkhorn Viaduct	On N-31, viaduct over Park/Papio/Union Pacific Railroad approximately 0.7 miles south of N-64. Begin R.P. – 24.40	\$4,500,000	\$4,500,000
2016-025	NDOR	I-680: West Center Road Bridge	On I-680 at West Center Road. Begin R.P. – 0.83	\$1,520,000	\$1,520,000
2016-026	NDOR	I-80: I-480 to 24th Street	On I-80 from I-480 to 24th Street. Begin R.P. – 453.01	\$6,762,000	\$6,762,000
2016-027	NDOR	N-370: I-80 to Bellevue	On N-370 from I-80 to NB US-75 ramp terminal in Bellevue. Begin R.P. – 4.19	\$500,000	\$500,000
2016-028	NDOR	District 2 I-80 Fiber-Optic	Along I-80 from near Mahoney interchange east to the Iowa State line. Begin R.P. – 426.90	\$2,426,000	\$2,426,000
2016-029	NDOR	District 2 I-680 Fiber-Optic	Along I-680 in Omaha	\$1,300,000	\$1,300,000
2016-030	NDOR	District 2 I-480 Fiber-Optic	Along I-480 in Omaha	\$467,000	\$467,000
2016-031	NDOR	US-75: Dynamic Message Signs, Omaha	Along northbound and southbound US-75 from approximately J Street to west of F Street in Omaha. Begin R.P. – 87.33	\$688,000	\$688,000
2016-032	NDOR	District 2 DMS	Along I-80, US-75, and US-34 in District 2. Begin R.P. – 428.92	\$2,065,000	\$2,065,000
2016-033	NDOR	District 2 CCTV Camera Towers	At eleven locations along I-80, I-680, US-75, US-34, and N-370 in District 2	\$485,000	\$485,000
2017-030	NDOR	US-6 Bridges at I-680	Bridge repair and overlay	\$4,500,000	\$4,500,000
2015-001	Omaha	North Downtown Riverfront Pedestrian Bridge	10th and Fahey Drive	\$5,848,500	\$6,558,500
2015-013	Omaha	Omaha Signal Infrastructure - Phase A	Various Locations Throughout City	\$4,447,500	\$4,447,500
2015-016	Omaha	Omaha ATMS Central System Software	Citywide	\$655,000	\$1,573,750
2015-017	Omaha	Omaha Signal Network - System Management	Various locations throughout the City of Omaha	\$500,000	\$500,000
2015-040	Omaha	156th Street Phase Two	Pepperwood Dr. to Corby St.	\$10,355,000	\$12,222,556
2015-044	Omaha	Q Street Bridge	Q St. between 26th St. and 27th St.	\$15,408,750	\$16,870,750
2015-051	Omaha	108th Street	Madison St to Q Street	\$6,431,250	\$6,771,250
2015-052	Omaha	168th Street	West Center Rd to Poppleton	\$5,908,750	\$6,466,250
2015-053	Omaha	114th Street	Burke to Pacific St	\$4,583,750	\$5,556,250
2015-054	Omaha	168th Street	West Center Rd to Q Street	\$12,292,500	\$12,959,190
2015-055	Omaha	120th Street	Stonegate Dr to Fort St	\$10,732,500	\$11,957,500
2015-065	Omaha	24th Street Road Diet	From L Street to Leavenworth Street.	\$3,395,000	\$3,395,000
2015-132	Omaha	132nd at West Center Road Safety Project	132nd Street from Kingswood to Arbor Plaza and West Center Road from 133rd Plaza to 130th Ave	\$2,001,000	\$2,313,500

Nebraska TIP Projects | FY 2016-2019

TIP ID	Lead Agency	Project Name	Improvement Location	Project Cost (FY2016-2019)	Total Project Cost
2015-157	Omaha	Omaha Signal Infrastructure - Phase B	Various Locations Throughout City	\$3,278,750	\$3,278,750
2015-158	Omaha	Omaha Signal Infrastructure - Phase C	Various Locations Throughout City	\$1,970,000	\$1,970,000
2015-159	Omaha	Omaha Signal Infrastructure - Phase D	Various Locations Throughout City	\$1,448,750	\$1,448,750
2016-045	Omaha	Omaha Resurfacing Program	Various locations throughout the City of Omaha	\$12,000,000	\$12,000,000
2015-010	Papillion	Schram Road 84th Street to 90th Street	Schram Road 84th Street to 90th Street	\$437,500	\$5,522,500
2015-041	PMNRD	Western Douglas County Trail Phase 2	City of Valley to Village of Waterloo	\$2,224,910	\$2,543,228
2015-042	PMNRD	Western Douglas County Trail Phase 1	City of Valley to Twin Rivers YMCA	\$3,224,655	\$3,586,055
2015-058	Sarpy	132nd and Giles	132nd and Giles Road	\$2,585,000	\$3,057,713
2015-062	Sarpy	66th and Giles	Harrison St. to 400ft. South of Giles Road and Giles Road from 69th St. to 66th St.	\$1,233,750	\$11,761,250
2015-138	Valley	Valley D.C. Safe Routes to School	Portion of Meigs Street in Valley, NE	\$225,000	\$270,000
<b>Total</b>				<b>\$352,104,104</b>	<b>\$429,347,597</b>

Iowa TIP Projects | FY 2016-2019

TIP ID	Lead Agency	Project Name	Improvement Location	Total Cost
2015-007	Pottawattamie	Pottawattamie County Multi-Use Trail - Phase 1	From Council Bluffs north to 330th Street along the Railroad Highway, approximately 7 miles	\$281,250
2015-014	Council Bluffs	Iowa Riverfront Trail III	Recreation Trail Connection Along Missouri River	\$286,250
2015-045	Council Bluffs	East Beltway Segments A-D	US-6 to IA-92	\$12,060,250
2015-056	Iowa DOT	I-80	I-80/I-29/I-480 Interstate Reconstruction	\$431,454,000
2015-060	Council Bluffs	River Rd. Trail	River Rd to Nebraska Ave.	\$307,500
2015-075	Council Bluffs	Interstate Utility Relocation	On I-29 at Mosquito Creek	\$1,863,000
2015-077	Council Bluffs	Kanesville Blvd Adaptive Traffic Signal Control	On Kanesville Boulevard, from 16th Street to North Avenue	\$486,000
2015-078	Council Bluffs	East Broadway Realignment at Kanesville Blvd	On Kanesville Boulevard from Frank Street to North Broadway	\$593,500
2015-079	Iowa DOT	US 275 Bridge Over Missouri River	US Highway 275 Bridge over Missouri River	\$1,236,000
2015-081	Iowa DOT	I-680 Bridge Over Missouri River - Westbound	On I-680 3.1 miles west of I-29	\$1,679,000
2015-082	Iowa DOT	I-680 Bridge Over Missouri River - Eastbound	On I-680 3.1 miles west of I-29	\$1,558,000
2015-085	Iowa DOT	I-80 Missouri River to Cass County	On I-80 from Missouri River to Cass County line	\$1,200,000
2015-086	Iowa DOT	I-29 Bridge at 9th Avenue - Southbound	I-29 at 9th Ave in Council Bluffs	\$250,000
2015-087	Iowa DOT	I-29 Bridge at 9th Avenue - Northbound	On I-29 at 9th Avenue in Council Bluffs	\$250,000
2016-034	Council Bluffs	North 16th Street Reconstruction	On 16th Street (Highway 192) from Avenue G to Nash Boulevard	\$5,625,000
2016-035	Council Bluffs	South Expressway Reconstruction - Phase 1	On Highway 192 from I-80 north to 21st Street	\$5,781,500
2016-039	Iowa DOT	I-80 Missouri River Bridge - Eastbound	On I-80 at Missouri River crossing in Council Bluffs	\$48,000
2016-040	Iowa DOT	I-80 Missouri River Bridge - Westbound	On I-80 at Missouri River crossing in Council Bluffs	\$48,000
2016-041	Iowa DOT	I-29: Mills County to Iowa 92	On I-29 from Mills County line to Iowa Highway 92 in Council Bluffs	\$250,000
2016-042	Iowa DOT	US-275 Missouri River Bridge	On US-275 at Missouri River crossing	\$572,000
2016-043	Iowa DOT	I-480: Missouri River to I-29	On I-480 from the Missouri River to I-29 in Council Bluffs	\$400,000
2016-044	Iowa DOT	I-480 Missouri River Bridge	On I-480 at the Missouri River crossing in Council Bluffs	\$1,218,000
<b>Total</b>				<b>\$467,447,250</b>

## Nebraska Short-Term Projects | FY 2020-2025

Lead Agency	Roadway	Location	Improvement Description	Program	Year	Total Cost
Bellevue	36th St Phase II	Sheridan Rd to Platteview Rd	Widen 2 Lane Rural to 4 Lane Urban	STP-MAPA	2020	\$8,955,000
Douglas County	180th St	Blondo St to Maple St	4 Lane Urban	STP-MAPA	2020	\$9,852,000
Douglas County	Q St	192nd St to N-31	4-Lane Divided with LTLs and RTLs	STP-MAPA	2025	\$7,251,234
<b>NDOR</b>	<b>I-680</b>	<b>I-680 / US-6 Bridges</b>	<b>On I-680 at US-6. Begin R.P. – 2.89</b>	<b>NHPP</b>	<b>2021</b>	<b>\$3,700,000</b>
Omaha	Citywide Resurfacing	Various Locations throughout City of Omaha	Advance Construction (AC) repayment of Omaha resurfacing projects	STP-MAPA	2021	\$6,227,000
Omaha	Citywide Resurfacing	Various Locations throughout City of Omaha	Advance Construction (AC) repayment of 2014 Resurfacing Package	STP-MAPA	2021	\$3,313,000
Omaha	180th St	West Dodge Road to HWS Cleveland Blvd	6-Lane Urban Divided	STP-MAPA	2021	\$3,641,400
Omaha	Industrial Road	132nd St to 144th St	Widen 4 Lane Divided Rural to 6 Lane Urban Divided with Turn Lanes	STP-MAPA	2025	\$11,803,338
Papillion	Schram Rd	84th St to 90th St	3 Lane with TWLTL	STP-MAPA	2023	\$5,556,517
Sarpy	66th Street	66th & Giles Intersection	Widening and reconstruction of roadway	STP-MAPA	2022	\$8,422,000
Sarpy County	New I-80 Interchange	At 180th Street	I-80 and 180th Street	STP-MAPA	2024	\$36,414,000
Sarpy County	Harrison St	168th - 156th St	4-Lane Divided with LTL	STP-MAPA	2025	\$13,684,381
Sarpy County	Platteview Rd	36th - 27th St	4-Lane Divided with LTLs	STP-MAPA	2025	\$7,640,429
<b>Total</b>						<b>\$126,460,299</b>

## Iowa Short-Term Projects | FY 2020-2025

[illegible]

## 7.7 FISCAL CONSTRAINT OVERVIEW FOR ROADWAY & TRAIL PROJECTS

In order to demonstrate fiscal constraint of the projects and revenues identified in this chapter, MAPA has included Tables 7.13 (below) and 7.14 (next page). These tables correlate the anticipated federal-aid highway revenues, local revenues, and estimated project costs to summarize the analysis conducted within this chapter. The positive balances shown in Table 7.13 below demonstrates that the identified Federal-Aid program of projects is fiscally constrained. Balances in the short-term bucket reflects the inability to program funding by year for non-regional sources of federal funding.

Table 7.14 (next page) summarizes non-federal-aid revenue and expenditures identified within this plan. The maps that follow this section show identified Federal-Aid investments, non-federal-aid projects, and all projects together.

**TABLE 7.13**  
**MAPA FEDERAL-AID FISCAL CONSTRAINT OVERVIEW (IN \$1,000s)**

### Anticipated Federal-Aid Revenues (in \$1,000s)

	TIP 2016-2019	Short Term 2020-2025	Medium Term 2026-2030	Long Term		Total
				2031-2035	2036-2040	
Iowa Federal-Aid	\$410,135	\$111,108	\$36,861	\$18,830	\$19,207	\$596,141
Nebraska Federal-Aid	\$212,209	\$132,456	\$126,811	\$130,614	\$134,533	\$736,623
Sub-Total	\$622,344	\$243,564	\$163,672	\$149,444	\$153,740	\$1,332,764
Iowa Match	\$57,309	\$24,055	\$7,464	\$23,423	\$15,946	\$128,197
Nebraska Match	\$139,895	\$24,917	\$28,759	\$16,608	\$13,955	\$224,134
Sub-Total	\$197,204	\$48,972	\$36,223	\$40,031	\$29,901	\$352,331
Iowa Total	\$467,444	\$135,163	\$44,325	\$59,884	\$35,153	\$741,969
Nebraska Total	\$352,104	\$157,373	\$157,153	\$147,222	\$148,488	\$962,340
Total Revenues	\$819,548	\$292,536	\$201,478	\$207,106	\$183,641	\$1,704,309

### Total Federal-Aid Project Costs (in \$1,000s)

	TIP 2016-2019	Short Term 2020-2025	Medium Term 2026-2030	Long Term		Total
				2031-2035	2036-2040	
Federal-Aid - IA	\$467,444	\$120,273	\$37,320	\$59,884	\$35,153	\$720,074
Federal-Aid - NE	\$352,104	\$126,460	\$151,710	\$147,222	\$148,488	\$925,984
Sub Total	\$819,548	\$246,733	\$189,030	\$207,106	\$183,641	\$1,646,058

### Balance of Federal-Aid Revenues & Expenditures (in \$1,000s)

	TIP 2016-2019	Short Term 2020-2025	Medium Term 2026-2030	Long Term		Total
				2031-2035	2036-2040	
Iowa Balance	\$0	\$14,890	\$7,005	\$0	\$0	\$21,895
Nebraska Balance	\$0	\$30,913	\$5,443	\$0	\$0	\$36,356
Regional Balance	\$0	\$45,803	\$12,448	\$0	\$0	\$58,251

Agenda Item E  
Funding Obligation and Project  
Status



# Funding Obligation and Project Status

Information Item



## MAPA Surface Transportation Program (STP) (NE)

FAST Act FY2016 Obligation Limit	Obligated Funds Through 07/31/16	Balance
\$13.224	\$0.883	\$12.341

## MAPA Transportation Alternatives Program (TAP) (NE)

(In \$Millions)

FAST Act FY2016 Obligation Limit	Obligated Funds Through 07/31/16	Balance
\$0.968	\$0.064	\$0.069

(In \$Millions)

FY2016 MAPA Regional STP Obligations (NE)

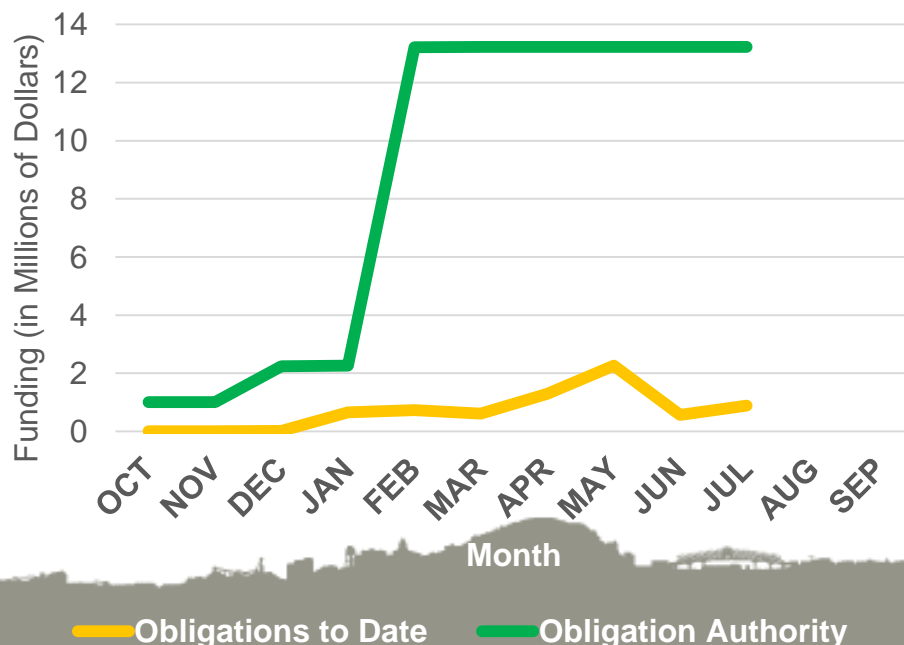

FY2016 MAPA Regional TAP Obligations (NE)

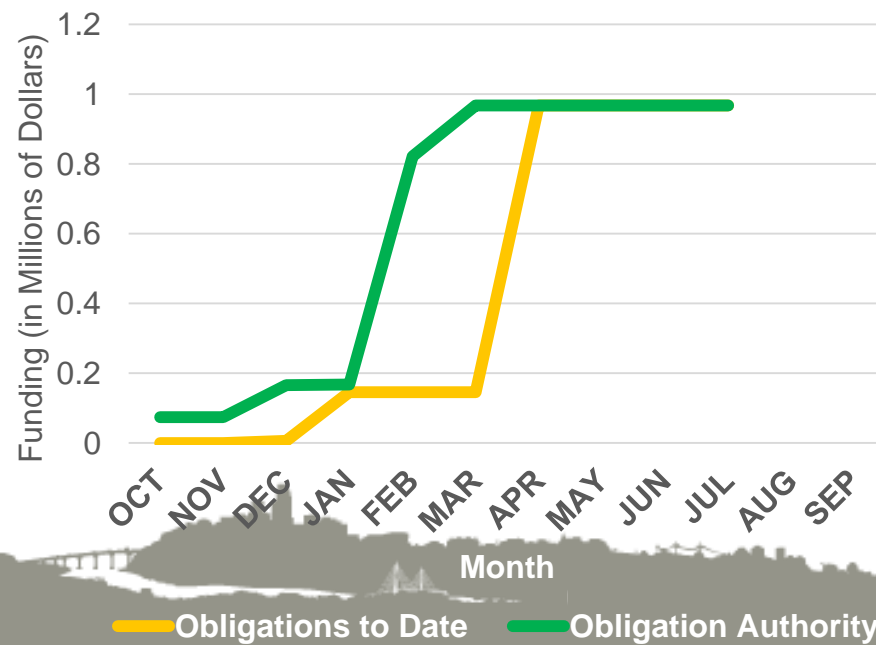

# Iowa Funding Status

	Highway Program	Enhancement Program
<b>Q3 Balance Before Obligations</b>	\$7,260	\$566
<b>Q3 Obligations</b>	\$0	\$0
<b>Q3 Ending Balance</b>	\$7,260	\$566

(In \$Millions)

# Fiscal Constraint

FY2016 - FY2019				
	Beginning Balance	Total Spending Authority	Total Projects	Ending Balance
STP-NE	\$ 43,470	\$ 60,112	\$ 101,930	\$ 1,652
STP-IA	\$ 8,706	\$ 7,939	\$ 15,600	\$ 1,045
TAP-NE	\$ 558	\$ 3,930	\$ 3,799	\$ 689
TAP-IA	\$ 287	\$ 760	\$ 700	\$ 347
5339/5307	\$ 24,520	\$ 37,902	\$ 60,135	\$ 2,287
5310	\$ 867	\$ 2,120	\$ 2,925	\$ 61

# MAPA Regional STP Funding - Nebraska

Lead Agency	Project Name	Comments	Control Number	FY2016	FY2017	FY2018	FY2019
Bellevue	36th Street Phase 1-370 – Sheridan		NE-22276-1	PE/ROW	C		
Bellevue	36th Street Phase II		NE-22276-2	PE/ROW			
Bennington	156th Street		NE-22233	PE/ROW	C		ACC
Douglas	180th Street (Phase 1)		NE-22224	PE	ROW		C
Omaha	108th Street		NE-22237	PE/ROW/U	C		
Omaha	114th Street (Pacific Street to Burke Street)		NE-22236	ROW		C	
Omaha	120th Street (Stonegate Drive to Roanoke Circle)		NE-22277	PE	ROW / U	C	
Omaha	156th Street (Phase 2)		NE-22376	ROW	C		
Omaha	168th Street (Q Street to West Center Road)		NE-22209	PE	ROW	C	
Omaha	168th Street (West Center Rd to Poppleton St.)		NE-22210	PE	ROW	C	
Omaha	42nd St Bridge C to D street	ACC in 16					ROW/A C
Omaha	Q Street Bridge	OA in FY 16	NE-22325	ROW	C		
Omaha	Omaha Signal Network – Infrastructure A-E	OA in FY 17	NE-22608 A-E		C	C	C
Omaha	Omaha Signal Infrastructure Phase 0	OA in FY 16	NE-22608	C			
Omaha	Omaha ATMS Central System Software	OA in FY 16	NE-22591	C			
Omaha	Omaha Signal Network - System Management	OA in FY 16	NE-22587	PE	PE		
Omaha	2014 Omaha Resurfacing Package		NE-22605	ACC			
Omaha	Resurfacing Project			AC	AC	AC	AC/ACC
Sarpy	132nd and Giles		NE-22283	ROW/C/U			
Sarpy	66th and Giles				PE	ROW	
MAPA/NDO R	Metro Area Travel Improvement Study		NE-22547	PLAN			



PE-NEPA-FD (PE)



Right-of-Way (ROW)



Construction/CE (C)



Transit Capital (PUR)

# MAPA Regional STP Funding - Iowa

Lead Agency	Project Name	Control Number	FY2016	FY2017	FY2018	FY2019
Council Bluffs	East Beltway Segments A-D	IA-13414				
	Eastern Hills Drive – Segment D				C	
	Greenview Road – East Segment			PE/ROW		C
	Greenview Road – West Segment				PE	
	Stevens Road – West Segment					PE
Council Bluffs	Interstate Utility Relocation	IA-15903				
	Interstate Utility Relocation		C	C	C	C
Council Bluffs	South Expressway Reconstruction Phase 1				C	
Council Bluffs	N 16 Street		C			

# MAPA Regional TAP Funding - Nebraska

Lead Agency	Project Name	Control Number	FY2016	FY2017	FY2018	FY2019
Metro	BRT	MET-11242014-001	C			
LaVista	Applewood Creek	LV-033115-001				PE
Omaha	North Downtown Ped Bridge	NE-22571	PE	C	C	

# MAPA Regional TAP Funding - Iowa

Lead Agency	Project Name	Control Number	FY2016	FY2017	FY2018	FY2019
Council Bluffs	Iowa Riverfront Trail III	IA-1581	C			
Council Bluffs	River Road Trail	IA-21087		C		
Pottawattamie	Multi-Use Trail – Phase I	IA-29802			C	



Agenda Item F  
Heartland 2050 Funding Allocation  
for Mini Grants



# Heartland 2050 Funding Allocation for Mini Grants

Information Item



# Heartland 2050 Mini Grants

- At the February TTAC meeting we introduced a plan for developing the mini grant program
- Progress since February:
  - Met with NDOR and laid out idea
    - Contract developed – currently under legal review
  - Requested and received approval from IDOT
  - Working internally to develop policy guide
    - Outlines Process – Application, Selection, Award



# Heartland 2050 Mini Grants

- Potential Projects
  - Main Street Tool Kit Planning Guide – pilot project with the City of Gretna
  - City of Council Bluffs BRT Expansion Feasibility Study
  - Expanded Bike Paths



Agenda Item G  
2050 LRTP Alternative Scoring

**Potential MAPA LRTP Project Scoring / Prioritization Approach, August 10, 2016**

Goal Area Weight - No Preservation	Goal Area Weight with Preservation	PM Weight for Project Scoring	System Performance Measure	Project Performance Measure	Score Type	Score Discussion
	10%	10%	Pavement – Nebraska Serviceability Index (NSI)	For roadway projects, project includes reconstruction of a corridor that requires preservation	Subdivide projects into 1-mile long segments. Consider worst condition of pavement or bridge along project. Current sufficiency levels: Good Pavement / Bridge - 0% Fair Pavement / Bridge - 50% Poor Pavement / Bridge - 10%	Good Pavement = Good or Excellent Fair Pavement = Fair Poor Pavement = Poor / Very Poor
			Pavement – International Roughness			
			Bridge - National Bridge Index (NBI)			
			Transit State-of-Good-Repair			
45%	41%	5%	System Reliability (Trucks Included)	Roadway project improves capacity on corridor with reliability issues, based on current Reliability Index (R180)	R180 > 1.60 = 100% of points 1.41 - 1.60 = 75% of points 1.21 - 1.40 = 50% of points 1.00 - 1.20 = 25% of points	Used relative points allocated for reliability from MAPA's STP policy guide. Use worst for AM or PM.
			VMT	Not useful at the project level.		
			VHT	Not usefule at the project level; rely on delay and congestion reduction measures.		
		16%	Delay	For roadway projects, project reduces delay in corridor compared to 2040 E+C. Delay measured in daily hours delay / mile.	Top Quartile Reduced Delay Corridors = 100% of points 2nd Quartile Reduced Delay Corridors = 75% of points 3rd Quartile Reduced Delay Corridors = 50% of points Lowest Quartile Reduced Delay Corridors = 25% of points No Reduced Delay = 0 points	Compare delay / mile reduced for all projects.
		20%	Miles of Congested Freeway (Mainline) Segments	For roadway projects, project reduces congested Miles in corridor compared to 2040 E+C. Measured in Congested Miles / Facility Mile.	Top Quartile Reduced Congestion Corridors = 100% of points 2nd Quartile Reduced Congestion Corridors = 75% of points 3rd Quartile Reduced Congestion Corridors = 50% of points Lowest Quartile Reduced Congestion Corridors = 25% of points. No Reduced Congestion = 0 points	Compare miles of reduced LOS E / F in corridors comparing Build to E+C.
			Miles of Congested Non-Freeway Segments			
25%	22%	4%	Regional Mode Share	For transit projects, project increases non-auto mode use.	For transit projects, number of new riders. Top Quartile Ridership Routes = 100% of points 2nd Quartile Ridership Routes = 75% of points 3rd Quartile Ridership Routes = 50% of points Lowest Quartile Ridership Routes = 25% of points	Compare estimated ridership on new transit lines in Build Scenario.
		3%	Access to Jobs	For each transit route, evaluate how much regional access to jobs improves.	For transit projects, percentage of jobs within 60 minute transit trip time. Top Quartile Transit Accessibility Routes = 100% of points 2nd Quartile Transit Accessibility Routes = 75% of points 3rd Quartile Transit Accessibility Routes = 50% of points Lowest Quartile Transit Accessibility Routes = 25% of points	Compare the results of each individual with the transit "no-build" scenario.
		3%	Proximity to Transit	For transit projects, how many new households and jobs are within 1/4 mile of transit line?	For transit projects, number of new houses and jobs: Top Quartile Emp + HH Corridors = 100% of points 2nd Quartile Emp + HH Corridors = 75% of points 3rd Quartile Emp + HH Corridors = 50% of points Lowest Quartile Emp + HH Corridors = 25% of points	Compare estimated ridership on new transit lines in Build Scenario.
		5%	Environmental Justice (EJ) Access to Jobs	For each transit route, evaluate how much EJ population access to jobs improves.	For transit projects, percentage of jobs within 60 minute transit trip time for EJ TAZs. Top Quartile EJ Transit Accessibility Routes = 100% of points 2nd Quartile EJ Transit Accessibility Routes = 75% of points 3rd Quartile EJ Transit Accessibility Routes = 50% of points Lowest Quartile EJ Transit Accessibility Routes = 25% of points	Compare the results of each individual with the transit "no-build" scenario.
		6%	EJ Proximity to Transit	For transit projects, how many new EJ households are within 1/4 mile of transit line?	For transit projects, number of new EJ households: Top Quartile EJ HH Corridors = 100% of points 2nd Quartile EJ HH Corridors = 75% of points 3rd Quartile EJ HH Corridors = 50% of points Lowest Quartile EJ HH Corridors = 25% of points	Includes both new service and improved service in existing transit corridors.
		1%	Proximity to Bicycle / Pedestrian Facilities	For bike/ped projects, how many new households and jobs are within 1/4 mile of bike / ped line?	For bike / ped projects, number of new houses and jobs: Top Quartile Emp + HH Corridors = 100% of points 2nd Quartile Emp + HH Corridors = 75% of points 3rd Quartile Emp + HH Corridors = 50% of points Lowest Quartile Emp + HH Corridors = 25% of points	Includes new routes / facilities and signed / shared corridors. Only bike / ped measure.
10%	9%	9%	Criteria Pollutant Emissions	For roadway projects, calculate percentage change in Criteria Pollutant Emissions in the Corridor / Mile - Build vs 2040 E+C.	For % change in criteria pollutant emissions (CPE): Top Quartile % reduction of CPE = 100% of points 2nd Quartile % reduction of CPE = 75% of points 3rd Quartile % reduction of CPE = 50% of points Lowest Quartile% reduction of CPE = 25% of points Segments with increase in CPE = 0 points	There is a good chance we will get little emissions benefits from any roadway projects.
			Sustainability Score	Not a usable measure at the project level; little differentiation.		
20%	18%	18%	Fatalities	For roadway projects, does it improve a corridor with safety issues.	Corridors with safety countermeasures instituted = 100%; Corridors with crash rates above # (threshold) and a capacity improvement = 50%	Those corridors with safety projects in them get the safety points.
			Serious Injuries			
			Fatalities per 100 MVMT			
			Serious Injuries per 100 MVMT			
			Non-motorized Fatalities and Serious Injuries			

100%

100%

100%

## Roadway Projects

## Transit Projects

## Bike / Ped Projects

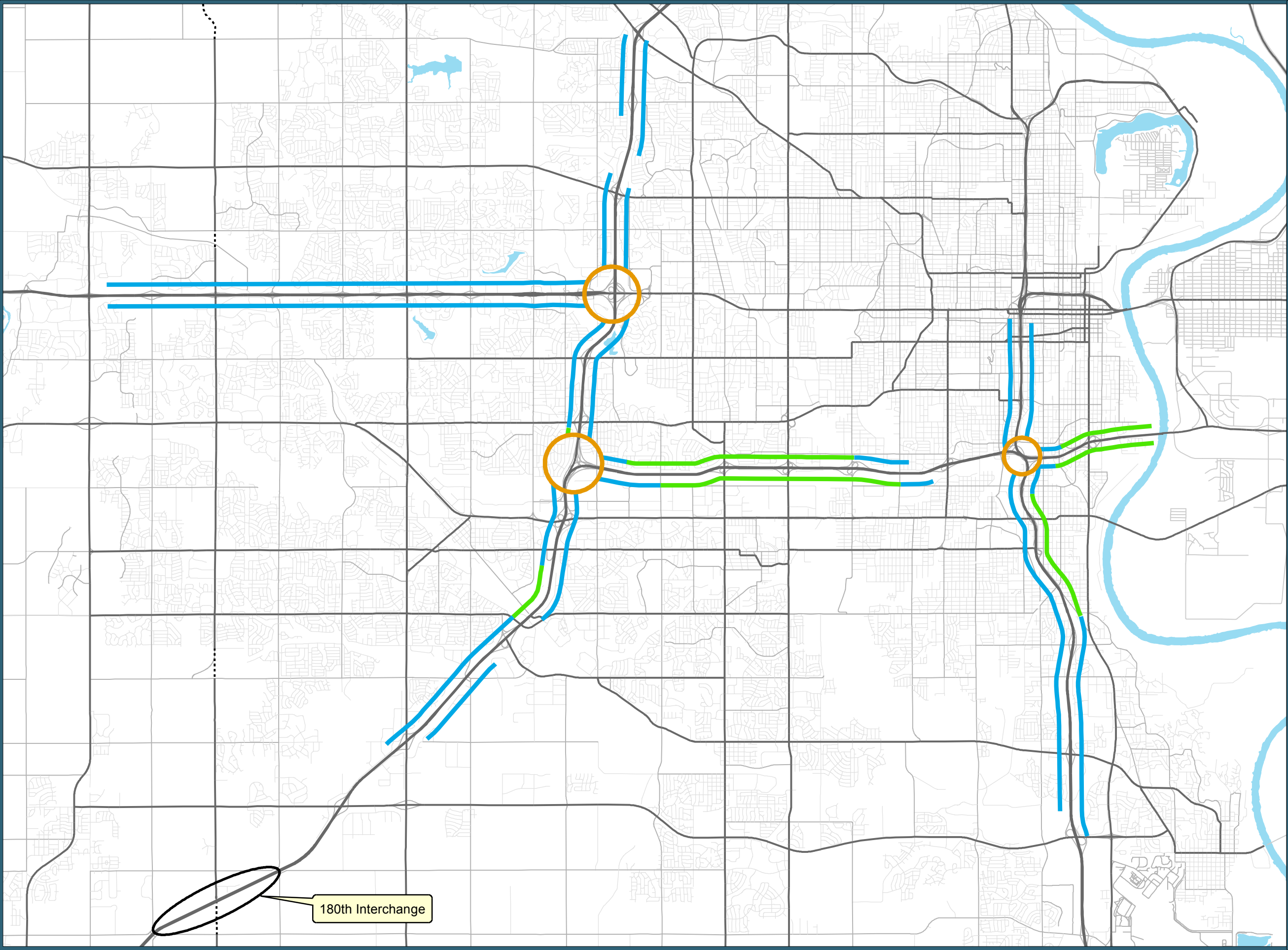

# Freeway Improvements

## Strategy Package 7

### Legend

- Widen # of Lanes
- 1
  - 2
  - Interchange Improvements

*Note that system interchange improvements are not yet defined.*





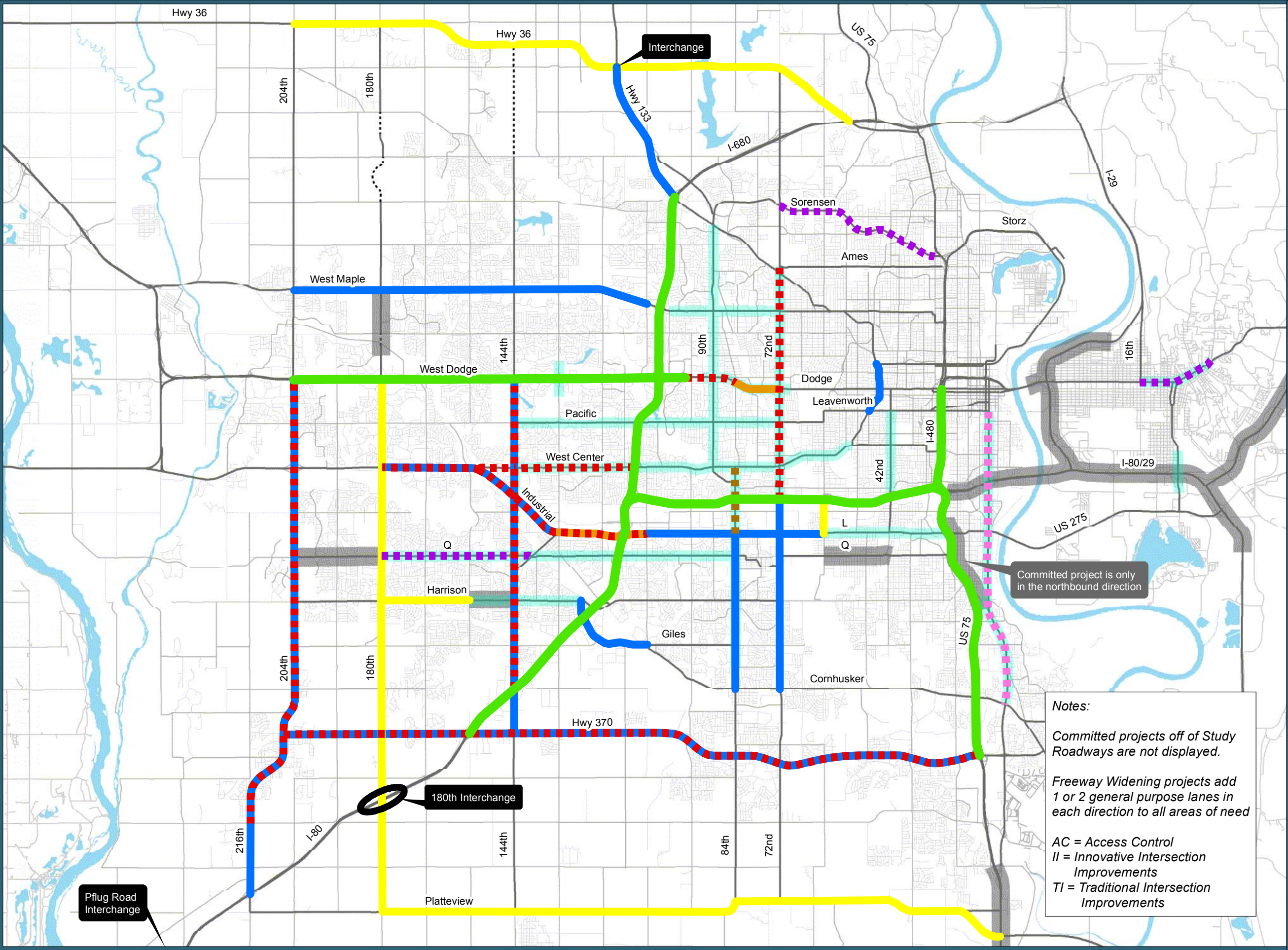

# Strategy Package #7

## Legend

### Freeway Widening

### Arterial Widening

- 4
- 6
- 8

### Arterial Other Strategies

- II
- II & AC
- TI
- AC

### ITS Corridors

### Committed Widening Projects

Notes:

Committed projects off of Study Roadways are not displayed.

Freeway Widening projects add 1 or 2 general purpose lanes in each direction to all areas of need

AC = Access Control  
II = Innovative Intersection Improvements  
TI = Traditional Intersection Improvements



# Strategy Package #7

## Legend

### Transit Projects

- Busway BRT
- BRT
- Streetcar
- Express

**P** Park & Ride

### Illustrative Projects

Vision

### Existing Transit System

Park & Ride

### Committed BRT Project



### Notes:

Additional transit improvements include increased headways on key central city routes.

BRT = Bus Rapid Transit

